

FUTEK MODEL Q11534 *INLINE MALE THREADED LOAD CELL*

INCH (mm)		R.O.= Rated Output	
WIRING CODE (WC 1)			
+Excitation RED	-Excitation BLACK	+Signal GREEN	-Signal WHITE

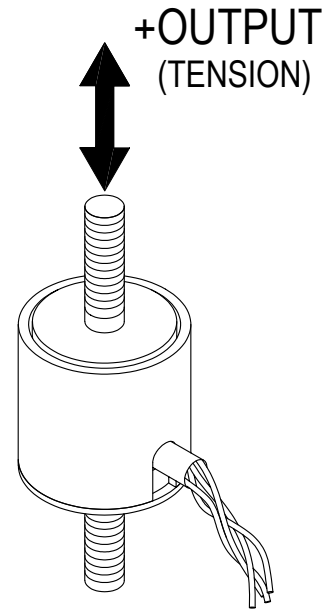
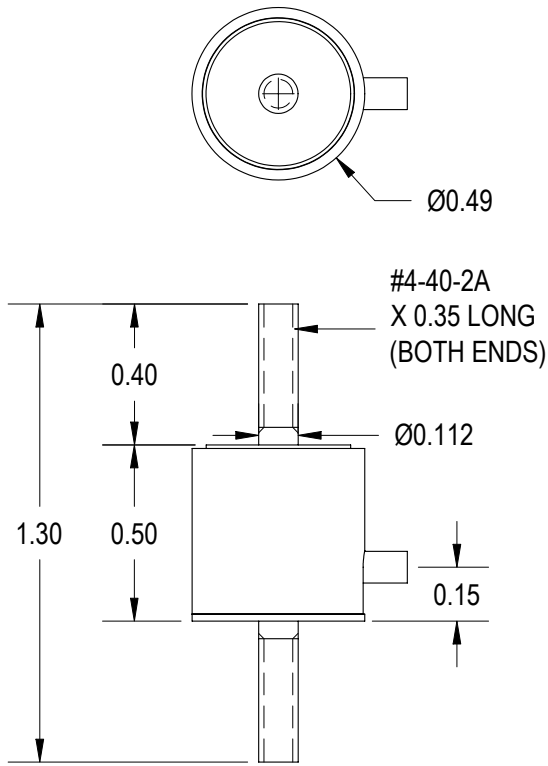

SPECIFICATIONS:

RATED OUTPUT	1 mV/V nom.
CAPACITY	50 lb
SAFE OVERLOAD	200% of R.O.
ZERO BALANCE	±3% of R.O.
EXCITATION (VDC OR VAC)	15 MAX
BRIDGE RESISTANCE	350 Ω nom
NONLINEARITY	±1% of R.O.
HYSTERESIS	±1% of R.O.
NONREPEATABILITY	±0.25% of R.O.
OPERATING TEMP.	-65 to 200°F
MATERIAL	17-4 PH S.S.
CABLE: #29 AWG, 4 Conductor, Spiral Shielded Silicone Cable, 6 in Long	

OUTLINE DRAWING

STANDARD NOTES: (Unless Otherwise Specified)

- ALL DIMENSIONS ARE IN INCHES
- DRAWING INTERPRETATION DIMS. PER ASME-Y14.5M
- REMOVE BURRS AND BREAK SHARP EDGES .005 - .015
- THREADS PER HANDBOOK H-28
- DIMENSIONS ARE SHOWN AFTER PLATING

ANGLE:
±1/2°

CHAMFER:
±5°

TOLERANCE:
.XX ±.01
.XXX ±.005

3rd ANGLE PROJ.

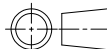

This drawing is submitted solely for the information and exclusive use of the original addressee. It is not to be divulged in whole or in part, by any firm or individual without written permission from:

FUTEK
ADVANCED SENSOR TECHNOLOGY, INC.
10 THOMAS
IRVINE, CA 92618 USA
Phone: (949) 465-0900
Fax: (949) 465-0905

MODEL: **Q11534**

DWG No.: **F4369**

DRAWN BY: **J. VARGAS**

CHECKED BY: **XXXXXX**

APPROVED BY: **R. WALKER**

DATE: **July 31, 2002**

MATERIAL:

—

HEAT TREATMENT - FINISH:

—

REVISIONS: (Refer to dwg # revision sheet)

△ XXXX