

# FUTEK MODEL Q10840

# DONUT/THRU HOLE LOADCELL

INCH (mm)		R.O.= Rated Output	
WIRING CODE (WC1)			
+Excitation	-Excitation	+Signal	-Signal
RED	BLACK	GREEN	WHITE

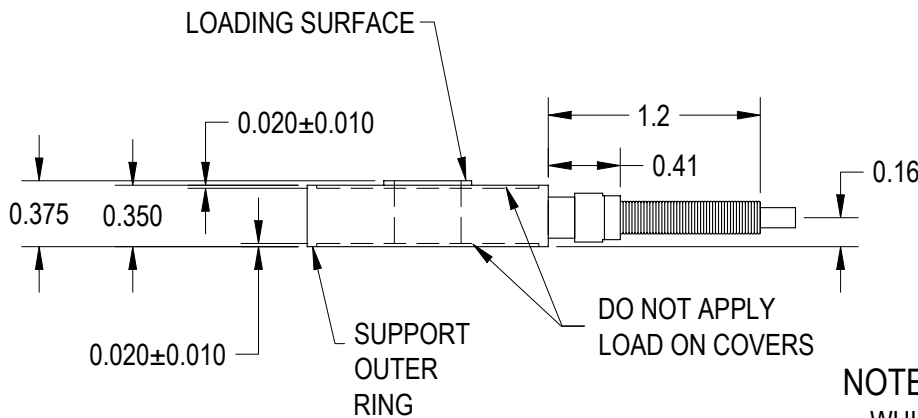
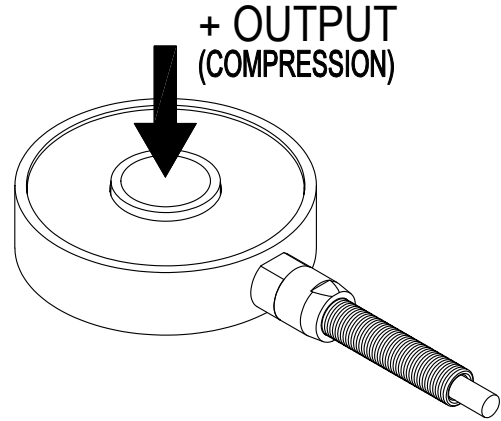
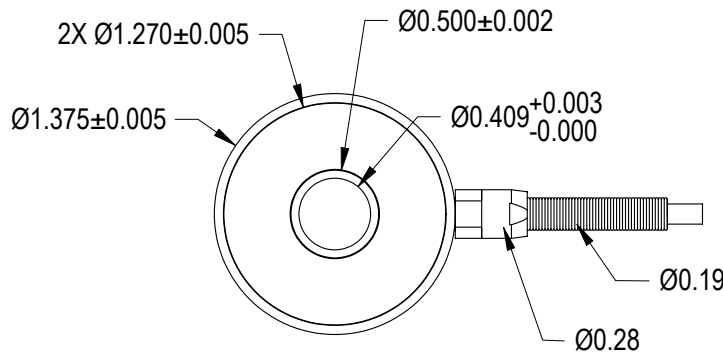

## SPECIFICATIONS:

<b>RATED OUTPUT</b>	2 mV/V nom.
<b>CAPACITY</b>	25 lb
<b>SAFE OVERLOAD</b>	150% of R.O.
<b>ZERO BALANCE</b>	±3% of R.O.
<b>EXCITATION (VDC OR VAC)</b>	18 MAX
<b>BRIDGE RESISTANCE</b>	700 Ω nom.
<b>NONLINEARITY</b>	±0.25% of R.O.
<b>HYSTERESIS</b>	±0.25% of R.O.
<b>NONREPEATABILITY</b>	±0.10% of R.O.
<b>TEMP. SHIFT ZERO</b>	±0.02% of R.O./°F
<b>TEMP. SHIFT SPAN</b>	±0.02% of LOAD/°F
<b>COMPENSATED TEMP.</b>	60 to 160°F
<b>OPERATING TEMP.</b>	0 to 160°F
<b>MATERIAL</b>	STAINLESS STEEL
<b>CABLE: 28 AWG, 4 Conductor Braided Shielded PVC Cable, 10 ft Long</b>	

## NOTE:

WHILE TORQUING BOLTS, HIGH TENSION FORCES WILL OCCUR DURING INSTALLATION, WHICH COULD RESULT IN OVERLOADING THE SENSOR. FUTEK RECOMMENDS CONNECTING SENSOR TO A SYSTEM IN ORDER TO MONITOR THE APPLIED FORCES. FUTEK IS NOT LIABLE OR RESPONSIBLE FOR THE MISHANDLING OF THE SENSOR DURING INSTALLATION.

## OUTLINE DRAWING

STANDARD NOTES: (Unless Otherwise Specified)

- ALL DIMENSIONS ARE IN INCHES
- DRAWING INTERPRETATION DIMS. PER ASME-Y14.5M
- REMOVE BURRS AND BREAK SHARP EDGES .005 - .015
- THREADS PER HANDBOOK H-28
- DIMENSIONS ARE SHOWN AFTER PLATING

ANGLE:  
±1/2°

CHAMFER:  
±5°

TOLERANCE:  
.XX ±.01  
.XXX ±.005

3rd ANGLE PROJ.

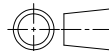

This drawing is submitted solely for the information and exclusive use of the original addressee. It is not to be divulged in whole or in part, by any firm or individual without written permission from:

**FUTEK**  
ADVANCED SENSOR TECHNOLOGY, INC.  
10 THOMAS  
IRVINE, CA 92618 USA  
Phone: (949) 465-0900  
Fax: (949) 465-0905

MATERIAL:

—

HEAT TREATMENT - FINISH:

—

REVISIONS: (Refer to dwg # revision sheet)

11-27-01

MODEL: **Q10840**

DWG No.: **F3925**

DRAWN BY: [Signature]

CHECKED BY: [Signature]

APPROVED BY: [Signature]

DATE: **Apr. 19, 2001**