

## Terms and Conditions of Use

This drawing, including all information depicted herein (collectively, "Drawing"), is FUTEK's property and protected under applicable law, including copyright. FUTEK reserves all rights. The Drawing is provided solely for your information and exclusive use. **Except as expressly approved by FUTEK in writing, you may not reproduce or share this Drawing**, in whole or part, with any other firm or individual, or attempt to reverse engineer the Drawing or data contained therein. Any reproduction of this Drawing in whole or part must include this legend.

By accessing the Drawing, you agree that you have read, understand, and agree to abide by the stated Terms and Conditions of Use.

© 2023 FUTEK Advanced Sensor Technology, Inc.

# FUTEK MODEL QLA146 COMPRESSION LOAD BUTTON

INCH (mm)		R.O.= Rated Output	
WIRING CODE			
+Excitation	-Excitation	+Signal	-Signal
GREEN	BLACK	WHITE	RED

PRELIMINARY  
DRAWING

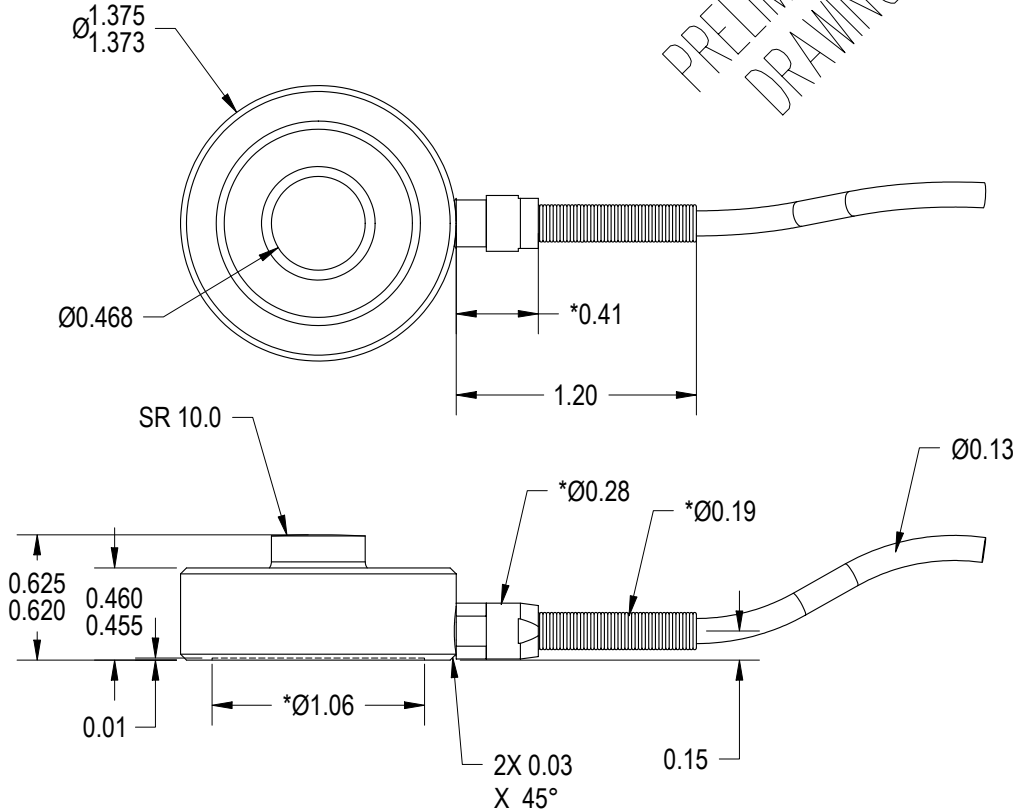
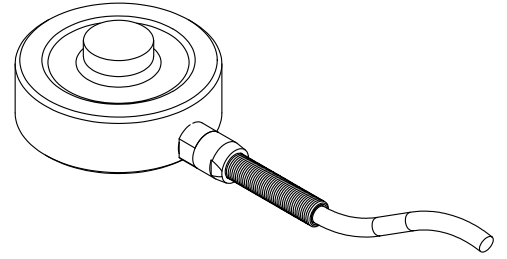

## SPECIFICATIONS:

CAPACITY	15000 lb
RATED OUTPUT	2 mV/V nom.
SAFE OVERLOAD	150% of R.O.
ZERO BALANCE	±3% of R.O.
EXCITATION (VDC OR VAC)	18 VDC MAX
BRIDGE RESISTANCE	*700 Ω nom.
COMBINED NONLINEARITY & HYSTERESIS	*±2% of R.O.
TEMP. SHIFT ZERO	±0.02% of R.O./°F
COMPENSATED TEMP.	70 to 250°F
OPERATING TEMP.	-60 to 250°F
MATERIAL	440C R56-60
CABLE:	26 AWG 4 Conductor Braided Shielded Teflon Cable, 40 ft long

## NOTE:

- 1) 12 POINT CALIBRATION
  - 6 POINTS LOADING
  - 6 POINTS UNLOADING
- 2) SUBMERSIBLE IN 15 PSI OF NON CONDUCTIVE OIL
- 3) (\*) DIMENSIONS/SPECS VARY FROM PRINT SUPPLIED BY CUSTOMER

MATERIAL:

—

HEAT TREATMENT - FINISH:

—

REVISIONS: (Refer to dwg # revision sheet)

▲ XXX

## OUTLINE DRAWING

STANDARD NOTES: (Unless Otherwise Specified)

- ALL DIMENSIONS ARE IN INCHES
- DRAWING INTERPRETATION DIMS. PER ASME-Y14.5M
- REMOVE BURRS AND BREAK SHARP EDGES .005 - .015
- THREADS PER HANDBOOK H-28
- DIMENSIONS ARE SHOWN AFTER PLATING

ANGLE:

±1/2°

CHAMFER:

±5°

TOLERANCE:

.XX ±.01

.XXX ±.005

3rd ANGLE PROJ.



This drawing, including all information depicted herein (collectively, "Drawing"), is FUTEK's property and protected under applicable law, including copyright. FUTEK reserves all rights. The Drawing is provided solely for your information and exclusive use. Except as expressly approved by FUTEK in writing, you may not reproduce or share this Drawing, in whole or part, with any other firm or individual, or attempt to reverse engineer the Drawing or data contained therein. Any reproduction of this Drawing in whole or part must include this legend.

# FUTEK

**CAGE: 1X8M6**

**MODEL: QLA146**

**DRAWN BY: J. VARGAS**

**APPROVED BY: R. WALKER**

**DWG No.: FO1019**

**CHECKED BY: XXXXX**

**DATE: Sep. 12, 2003**