

Terms and Conditions of Use

This drawing, including all information depicted herein (collectively, "Drawing"), is FUTEK's property and protected under applicable law, including copyright. FUTEK reserves all rights. The Drawing is provided solely for your information and exclusive use. **Except as expressly approved by FUTEK in writing, you may not reproduce or share this Drawing**, in whole or part, with any other firm or individual, or attempt to reverse engineer the Drawing or data contained therein. Any reproduction of this Drawing in whole or part must include this legend.

By accessing the Drawing, you agree that you have read, understand, and agree to abide by the stated Terms and Conditions of Use.

© 2023 FUTEK Advanced Sensor Technology, Inc.

FUTEK MODEL Q10316 CRYOGENIC COMPRESSION LOAD CELL

INCH (mm)		R.O.= Rated Output	
WIRING CODE (WC 1)			
+Excitation	-Excitation	+Signal	-Signal
RED	BLACK	GREEN	WHITE

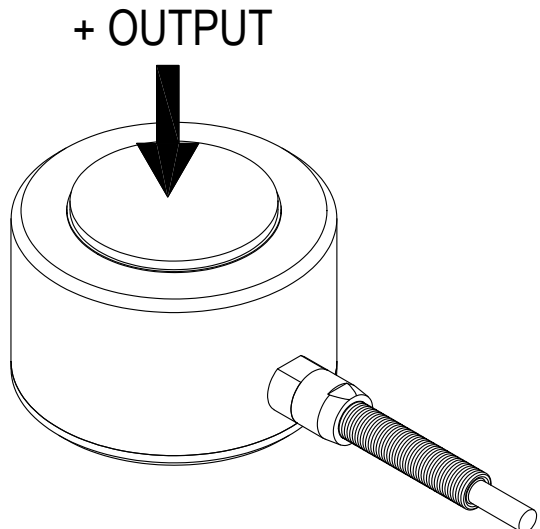
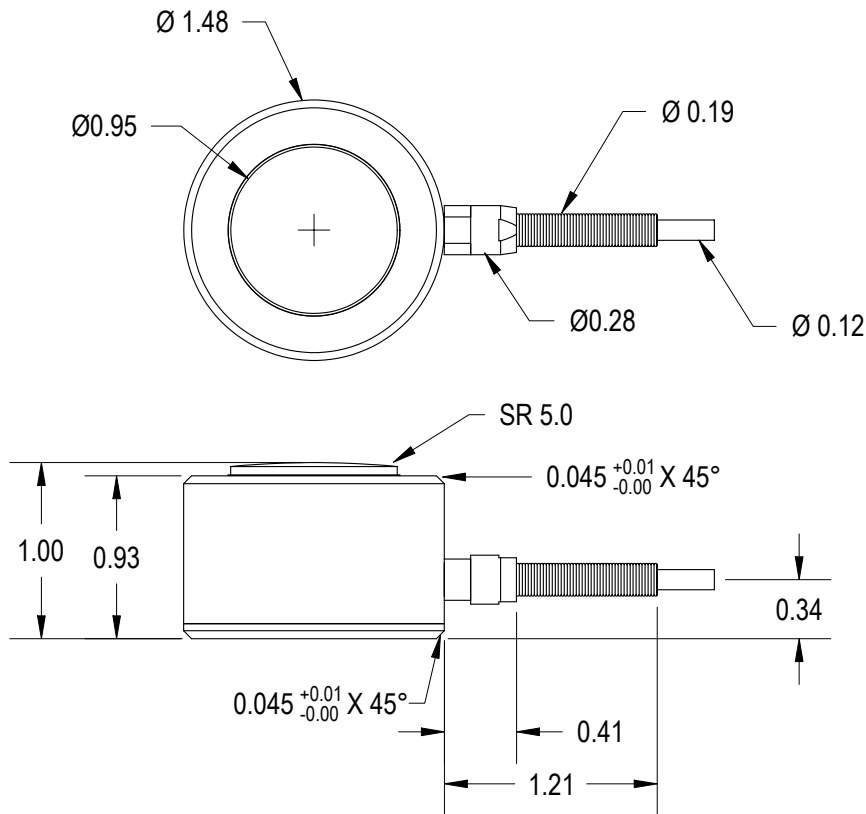

SPECIFICATIONS:

RATED OUTPUT	2 mV/V nom.
CAPACITY	15000 lb
SAFE OVERLOAD	150% of R.O.
ZERO BALANCE	±3% of R.O.
EXCITATION (VDC OR VAC)	10 Recommended, 18 MAX
BRIDGE RESISTANCE	350 / 700 Ω nom.
NONLINEARITY	±3% of R.O.
NONREPEATABILITY	±1% of R.O.
TEMP. SHIFT ZERO	±0.1% of R.O./°F
TEMP. SHIFT SPAN	±0.1% of LOAD/°F
OPERATING TEMP.	-250 to 150°F
MATERIAL	Stainless Steel
CABLE: 26AWG, 4 Conductor Braided Shield Teflon Cable, 10 ft. Long	

OUTLINE DRAWING

- STANDARD NOTES: (Unless Otherwise Specified)
- ALL DIMENSIONS ARE IN INCHES
 - DRAWING INTERPRETATION DIMS. PER ASME-Y14.5M
 - REMOVE BURRS AND BREAK SHARP EDGES .005 - .015
 - THREADS PER HANDBOOK H-28
 - DIMENSIONS ARE SHOWN AFTER PLATING

ANGLE:
±1/2°

CHAMFER:
±5°

TOLERANCE:
.XX ±.01
.XXX ±.005

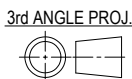

FUTEK

This drawing, including all information depicted herein (collectively, "Drawing"), is FUTEK's property and protected under applicable law, including copyright. FUTEK reserves all rights. The Drawing is provided solely for your information and exclusive use. Except as expressly approved by FUTEK in writing, you may not reproduce or share this Drawing, in whole or part, with any other firm or individual, or attempt to reverse engineer the Drawing or data contained therein. Any reproduction of this Drawing in whole or part must include this legend.

MATERIAL: —
HEAT TREATMENT - FINISH: —
REVISIONS: (Refer to dwg # revision sheet) A 11-29-00

MODEL: Q10316	DWG No.: F3729
DRAWN BY: R. WALKER	CHECKED BY: XXXXX
APPROVED BY: J. MOKHBERY	DATE: Sept. 25, 2000