

FUTEK MODEL QLA192 AMPLIFIED LOAD SENSING CLEVIS PIN

STOCK NUMBER: QSH00345

INCH (mm)		R.O.= Rated Output
WIRING CODE		
12-24 VDC PIN A	RETURN PIN B	0-5 VDC OUTPUT PIN C

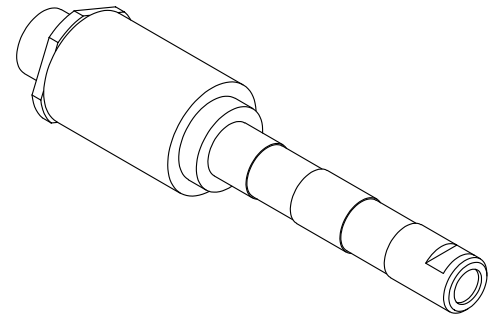
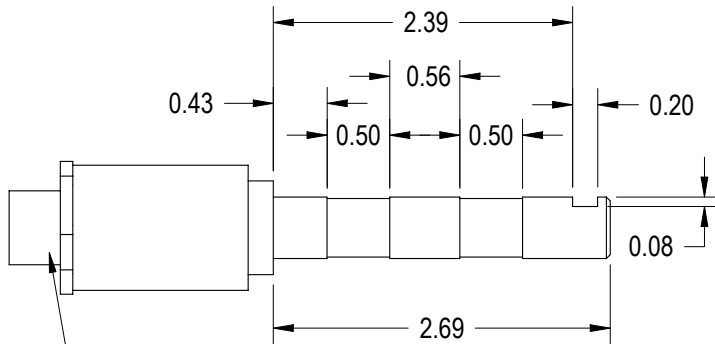
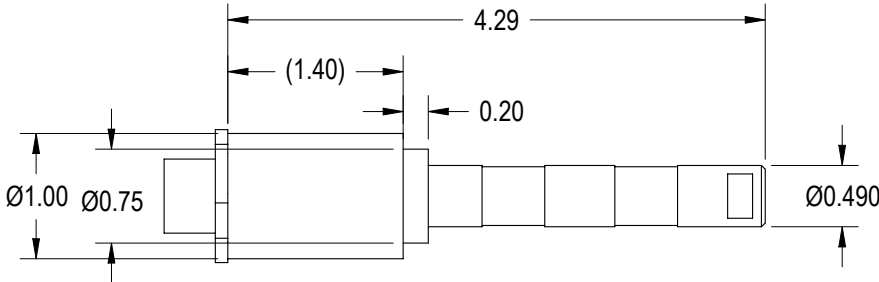

PRELIMINARY
DRAWING

BENDIX RECEPTACLE
PT04A-10-6P
MATING CONNECTOR
PT06A-10-6S-SR
(NOT INCLUDED)

APPLY LOAD UNIFORMLY TO
CENTER SECTION

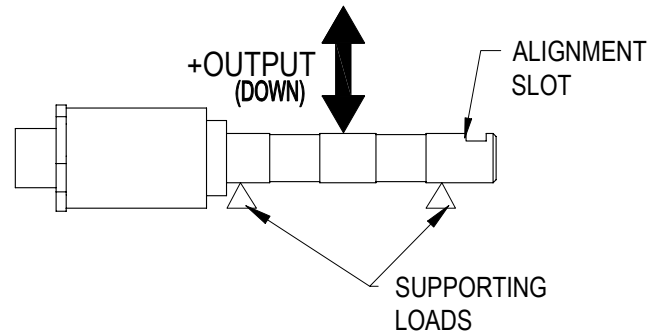

SPECIFICATIONS:

RATED OUTPUT	±2 VDC nom.
CAPACITY	1500 lb
SAFE OVERLOAD	150% of R.O.
ZERO BALANCE	2.5 ±0.1 VDC @ 75°F
EXCITATION	12-24 VDC
NONLINEARITY	±2% of R.O.
NONREPEATABILITY	±0.25% of R.O.
TEMP. SHIFT ZERO	±0.03% of R.O./°F
TEMP. SHIFT SPAN	±0.03% of LOAD/°F
COMPENSATED TEMP.	60 to 160°F
OPERATING TEMP.	-40 to 180°F
MATERIAL	STAINLESS STEEL
CONNECTOR:	6 Pin BENDIX Receptacle (PT04A-10-6P)

- Amplifier Housing Diameter changed from Ø1.12 to Ø1.0
- Sensor Diameter changed from Ø1.0 to Ø0.75
- Added 0.20 Wide x 0.08 Deep Alignment Slot

MATERIAL:
—

HEAT TREATMENT - FINISH:
—

REVISIONS: (Refer to dwg # revision sheet)

▲ 07-08-04

OUTLINE DRAWING

STANDARD NOTES: (Unless Otherwise Specified)

- ALL DIMENSIONS ARE IN INCHES
- DRAWING INTERPRETATION DIMS. PER ASME-Y14.5M
- REMOVE BURRS AND BREAK SHARP EDGES .005 - .015
- THREADS PER HANDBOOK H-28
- DIMENSIONS ARE SHOWN AFTER PLATING

ANGLE:
±1/2°

CHAMFER:
±5°

TOLERANCE:
.XX ±.01
.XXX ±.005

3rd ANGLE PROJ.



This drawing is submitted solely for the information and exclusive use of the original addressee. It is not to be divulged in whole or in part, by any firm or individual without written permission from:

FUTEK
ADVANCED SENSOR TECHNOLOGY, INC.

10 THOMAS
IRVINE, CA 92618 USA
Phone: (949) 465-0900
Fax: (949) 465-0905

CAGE: 1X8M6

MODEL: QLA192

DWG No.: FO1046

DRAWN BY: J. VARGAS

CHECKED BY: R. WALKER

APPROVED BY: J. MOKHBERY

DATE: April 24, 2004