

Terms and Conditions of Use

This drawing, including all information depicted herein (collectively, "Drawing"), is FUTEK's property and protected under applicable law, including copyright. FUTEK reserves all rights. The Drawing is provided solely for your information and exclusive use. **Except as expressly approved by FUTEK in writing, you may not reproduce or share this Drawing**, in whole or part, with any other firm or individual, or attempt to reverse engineer the Drawing or data contained therein. Any reproduction of this Drawing in whole or part must include this legend.

By accessing the Drawing, you agree that you have read, understand, and agree to abide by the stated Terms and Conditions of Use.

© 2023 FUTEK Advanced Sensor Technology, Inc.

FUTEK MODEL QLA208 Collet Force Sensor w/ Display

STOCK NUMBER: QSH00427

INCH (mm) | R.O.= Rated Output

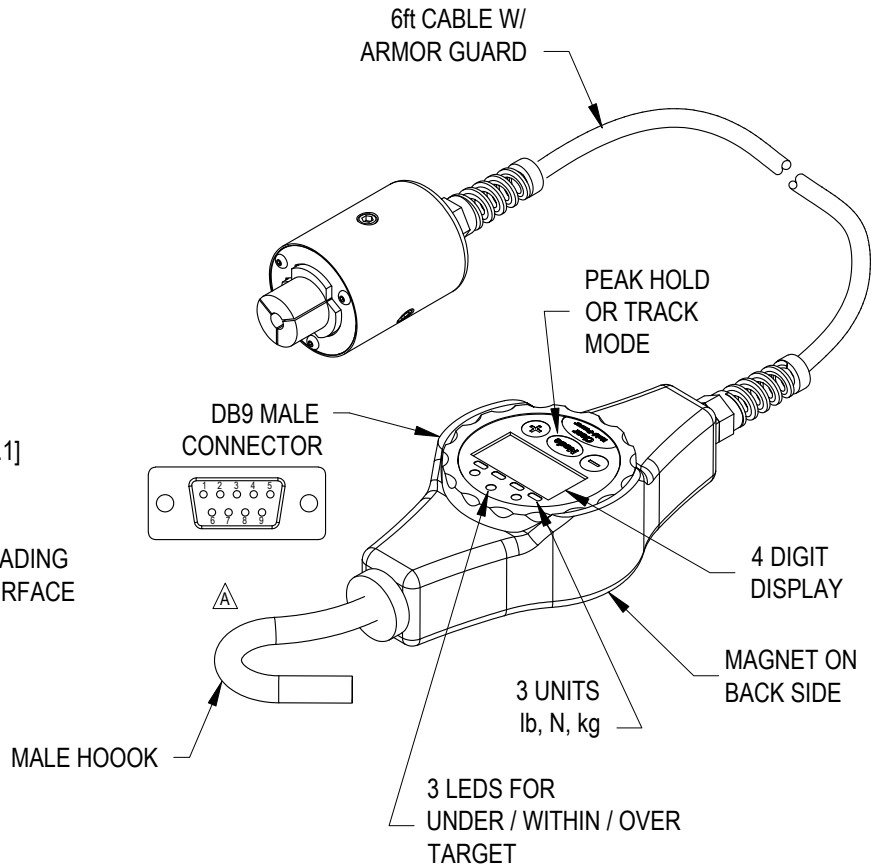
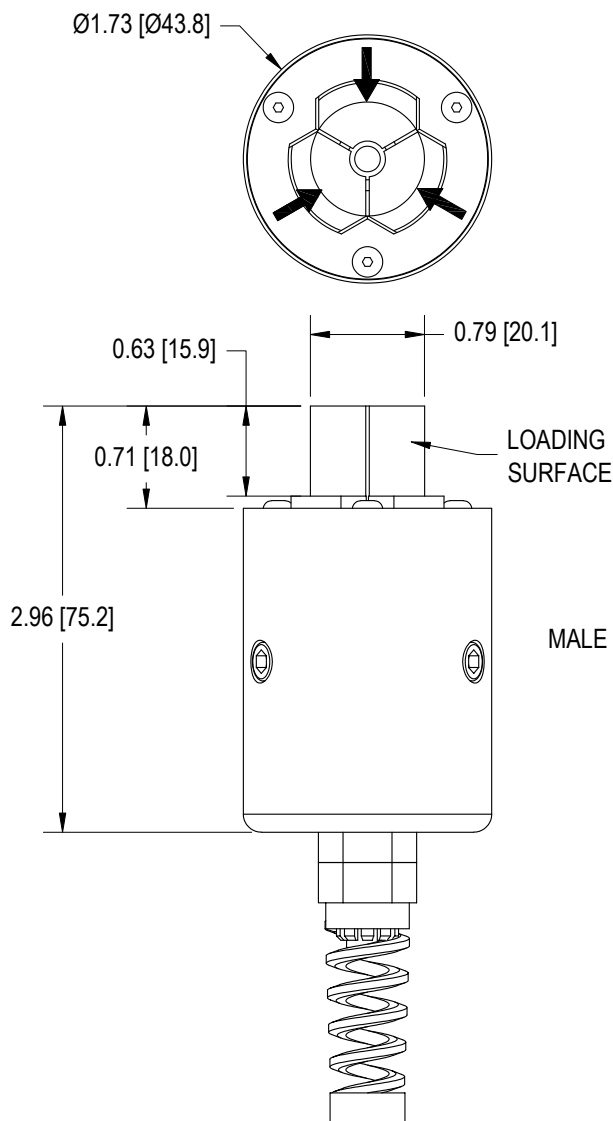

SPECIFICATIONS:

CAPACITY	500 lb
SAFE OVERLOAD	150% of R.O.
OPERATING TEMP.	0 to 150°F
EXCITATION	9 Volt Battery

DB9 CONNECTION

*PIN 6	-P BATTERY/COMMON
PIN 7	ANALOG (RETURN)
PIN 8	ANALOG OUT (0-1 VDC)
*PIN 9	+P BATTERY

*REMOVE BATTERY BEFORE POWERING

MATERIAL:

—

HEAT TREATMENT - FINISH:

—

REVISIONS: (Refer to dwg # revision sheet)

10-07-04

OUTLINE DRAWING

STANDARD NOTES: (Unless Otherwise Specified)

- ALL DIMENSIONS ARE IN INCHES
- DRAWING INTERPRETATION DIMS. PER ASME-Y14.5M
- REMOVE BURRS AND BREAK SHARP EDGES .005 - .015
- THREADS PER HANDBOOK H-28
- DIMENSIONS ARE SHOWN AFTER PLATING

ANGLE:
±1/2°

CHAMFER:
±5°

TOLERANCE:
.XX ±.01
.XXX ±.005

3rd ANGLE PROJ.



This drawing, including all information depicted herein (collectively, "Drawing"), is FUTEK's property and protected under applicable law, including copyright. FUTEK reserves all rights. The Drawing is provided solely for your information and exclusive use. **Except as expressly approved by FUTEK in writing, you may not reproduce or share this Drawing** in whole or part, with any other firm or individual or attempt to reverse engineer the Drawing or data contained therein. Any reproduction of this Drawing in whole or part must include this legend.

FUTEK

CAGE: 1X8M6

MODEL: QLA208

DRAWN BY: R. WALKER

APPROVED BY: J. VARGAS

DWG No.: FO1057

CHECKED BY: XXXXX

DATE: Aug 24, 2004