

# FUTEK MODEL QLA285

# PARALLEL BEAM LOAD CELL

ITEM NUMBER: SEE CHART



INCH [mm]		R.O. = Rated Output	
WIRING CODE			
+ Excitation	- Excitation	+ Signal	- Signal
RED	WHITE	BLUE	GREEN
Shield			
FLOATING			

PROTECTIVE COATING BOTH SIDES

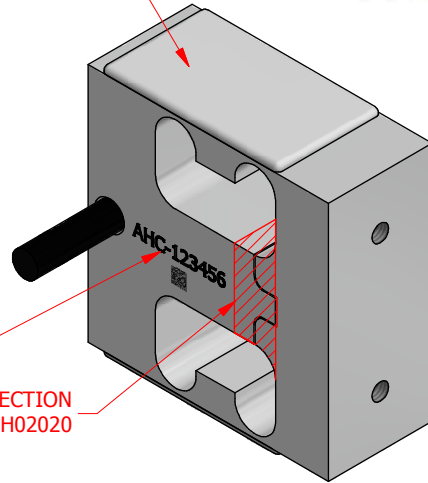

S/N WITH DATAMATRIX

OVERLOAD PROTECTION NOT AVAILABLE ON QSH02020

- OUTPUT  
↑  
↓  
+ OUTPUT

PROTECTIVE COATING

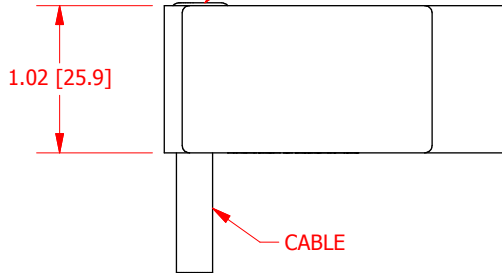

CABLE

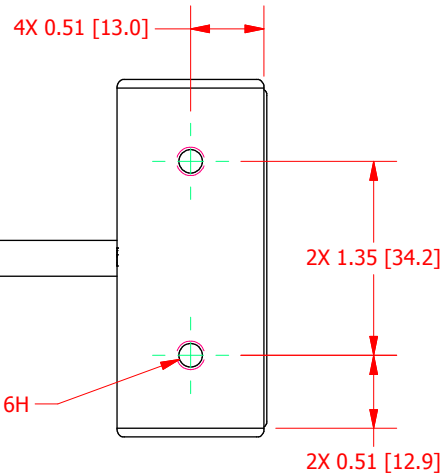
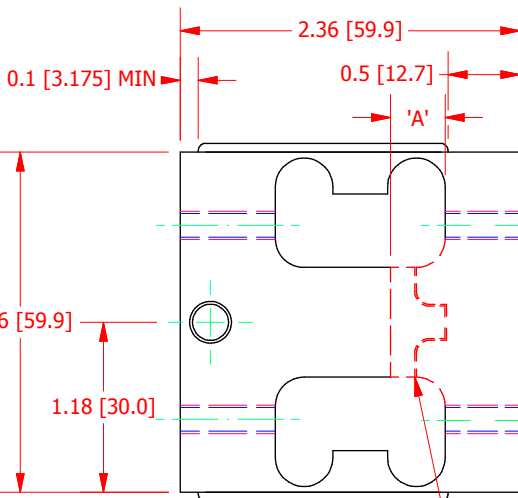

4X M5x0.8 - 6H

OVERLOAD PROTECTION NOT AVAILABLE ON QSH02020

## SPECIFICATIONS:

RATED OUTPUT	2 mV/V nom.
CAPACITY	15 lb. [66.6N]
SAFE OVERLOAD	See Chart
ZERO BALANCE	±2% of R.O.
EXCITATION (VDC OR VAC)	18 MAX
BRIDGE RESISTANCE	350 Ω nom.
NONLINEARITY	±0.05% of R.O.
HYSTERESIS	±0.05% of R.O.
NONREPEATABILITY	±0.01% of R.O.
TEMP. SHIFT ZERO	±0.01% of R.O./°F (±0.018 of R.O./°C)
TEMP. SHIFT SPAN	±0.01% of LOAD/°F (±0.018 of LOAD/°C)
COMPENSATED TEMP.	60 to 160 °F (16 to 71 °C)
OPERATING TEMP	0 to 160 °F (-18 to 71 °C)
WEIGHT (approx)	0.4 lb [181.4 g]
MATERIAL	Aluminum
CABLE: #26 Awg 4 Conductor Shielded Cable, 8 in [20 cm] Long	
RoHS 2011/65/EU Compliant	

ITEM#	OVERLOAD PROTECTION	'A'	SAFE OVERLOAD
QSH02019	YES	0	150 lb [667 N]
QSH02020	NO	0.38 [9.65]	22.5 lb [100 N]

CUSTOMER APPROVAL- COMPANY:

## OUTLINE DRAWING

This drawing is submitted solely for the information and exclusive use of the original addressee. It is not to be divulged in whole or in part, by any firm or individual without written permission from:

**FUTEK**  
ADVANCED SENSOR TECHNOLOGY, INC.  
10 THOMAS, IRVINE, CA 92618 USA  
Phone: (949) 465-0900  
Fax: (949) 465-0905

CUSTOMER APPROVAL- NAME / DATE:

STANDARD NOTES: (Unless Otherwise Specified)

ALL DIMENSIONS ARE IN INCHES  
DRAWING INTERPRETATION DIMS. PER ASME-Y14.5M  
REMOVE BURRS AND BREAK SHARP EDGES .005 - .015  
THREADS PER HANDBOOK H-28  
DIMENSIONS ARE SHOWN AFTER PLATING

ANGLE:  
± 1/2°

CHAMFER:  
± 5°

TOLERANCE:  
.X ± 0.1"  
.XX ± 0.01"  
.XXX ± 0.005"

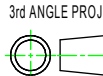

MODEL: <b>QLA285</b>	DWG No.: <b>FO1476</b>
DRAWN BY: S. MICHEL	CREATED DATE: 8/24/2018
APPROVED BY: R. WALKER	APPROVED DATE: 9/13/2018
CHECKED BY:	CAGE: 1X8M6 SHEET: 1 OF 1

REVISIONS: (Refer to dwg # revision sheet)