

FUTEK MODEL QLA381

SUBMINIATURE, THREADED, COMPRESSION LOAD CELL

ITEM NUMBER: QSH01833

INCH [mm]		R.O.= Rated Output	
WIRING CODE			
+ Excitation	- Excitation	+ Signal	- Signal
RED	BLACK	GREEN	WHITE
Shield			
GROUNDED			

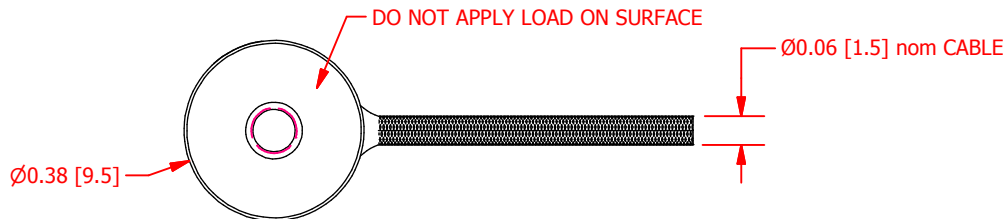
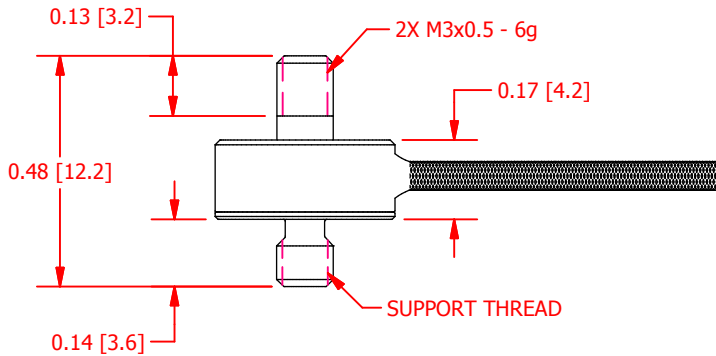
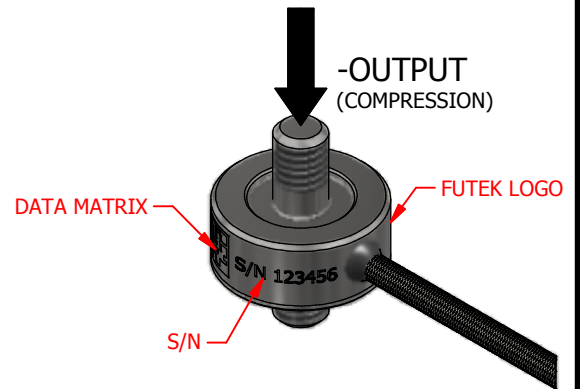
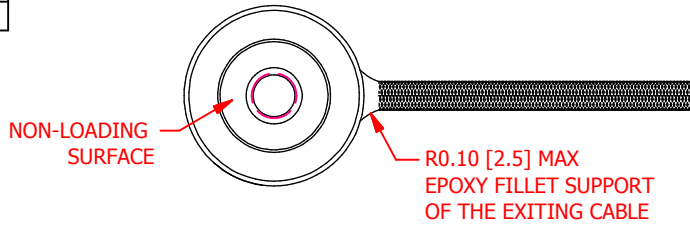

SPECIFICATIONS:

CAPACITY	1000 g
RATED OUTPUT	1 mV/V nom.
SAFE OVERLOAD	150 % of R.O.
ZERO BALANCE	±6% of R.O.
EXCITATION (VDC OR VAC)	12 MAX
BRIDGE RESISTANCE	1000 Ω nom.
NONLINEARITY	±0.5% of R.O.
HYSTERESIS	±0.5% of R.O.
NONREPEATABILITY	±0.1% of R.O.
TEMP. SHIFT ZERO	±0.01% of R.O./°F (±0.018 of R.O./°C)
TEMP. SHIFT SPAN	±0.01% of LOAD/°F (±0.018 of LOAD/°C)
COMPENSATED TEMP.	60 to 160 °F (16 to 71 °C)
OPERATING TEMP.	-60 to 200 °F (-51 to 93 °C)
WEIGHT (approx)	0.3 oz [8.5 g]
MATERIAL	17-4 PH.S.S.
IP RATING	IP 64
CABLE: #34 Avg 4 Conductor Braided Shielded Cable, 5 ft [1.5 m] Long	
CALIBRATION	Compression - 5pt to 100g

CUSTOMER APPROVAL- COMPANY:	<h2>OUTLINE DRAWING</h2>	<p><i>This drawing is submitted solely for the information and exclusive use of the original addressee. It is not to be divulged in whole or in part, by any firm or individual without written permission from:</i></p> <p>FUTEK ADVANCED SENSOR TECHNOLOGY, INC. 10 THOMAS, IRVINE, CA 92618 USA Phone: (949) 465-0900 Fax: (949) 465-0905</p>
CUSTOMER APPROVAL- NAME / DATE:		
REVISIONS: (Refer to dwg # revision sheet)	<p>STANDARD NOTES: (Unless Otherwise Specified)</p> <p>ALL DIMENSIONS ARE IN INCHES DRAWING INTERPRETATION DIMS. PER ASME-Y14.5M REMOVE BURRS AND BREAK SHARP EDGES .005 - .015 THREADS PER HANDBOOK H-28 DIMENSIONS ARE SHOWN AFTER PLATING</p> <p>ANGLE: ± 1/2° CHAMFER: ± 5° TOLERANCE: .X ± 0.1" .XX ± 0.01" .XXX ± 0.005"</p> <p>3rd ANGLE PROJ.</p>	<p>MODEL: QLA381 DWG No.: FO1418</p> <p>DRAWN BY: M. Lisiak CREATED DATE: 2/2/2016</p> <p>APPROVED BY: R. Walker APPROVED DATE: 2/3/2016</p> <p>CHECKED BY:</p>
		CAGE: 1X8M6 SHEET: 1 OF 1