

## Terms and Conditions of Use

This drawing, including all information depicted herein (collectively, "Drawing"), is FUTEK's property and protected under applicable law, including copyright. FUTEK reserves all rights. The Drawing is provided solely for your information and exclusive use. **Except as expressly approved by FUTEK in writing, you may not reproduce or share this Drawing**, in whole or part, with any other firm or individual, or attempt to reverse engineer the Drawing or data contained therein. Any reproduction of this Drawing in whole or part must include this legend.

By accessing the Drawing, you agree that you have read, understand, and agree to abide by the stated Terms and Conditions of Use.

© 2023 FUTEK Advanced Sensor Technology, Inc.

# FUTEK MODEL QMA123 Custom Torque/Thrust Bi-Axial Sensor

ITEM NUMBER: QSH01319

INCH [mm]		R.O.= Rated Output	
<b>WIRING CODE</b>			
+Excitation	-Excitation	+Signal	-Signal
RED	BLACK	GREEN	WHITE
Shield			
Floating			

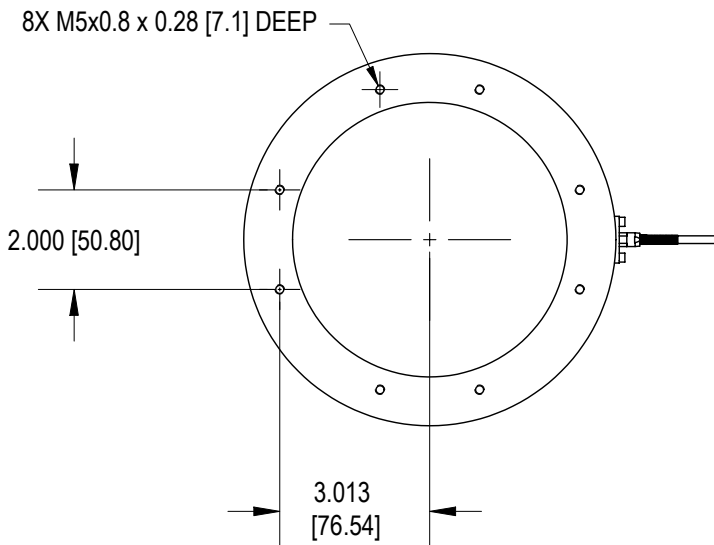
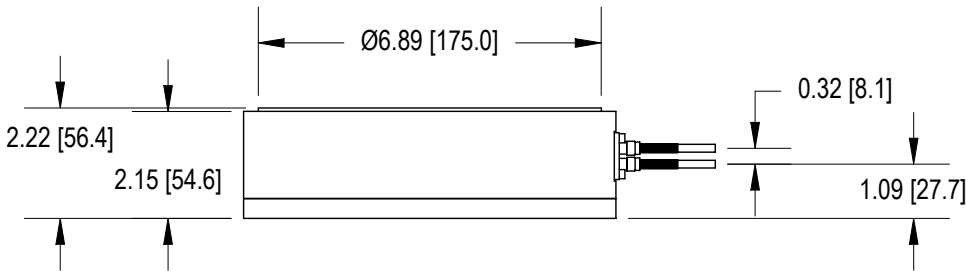
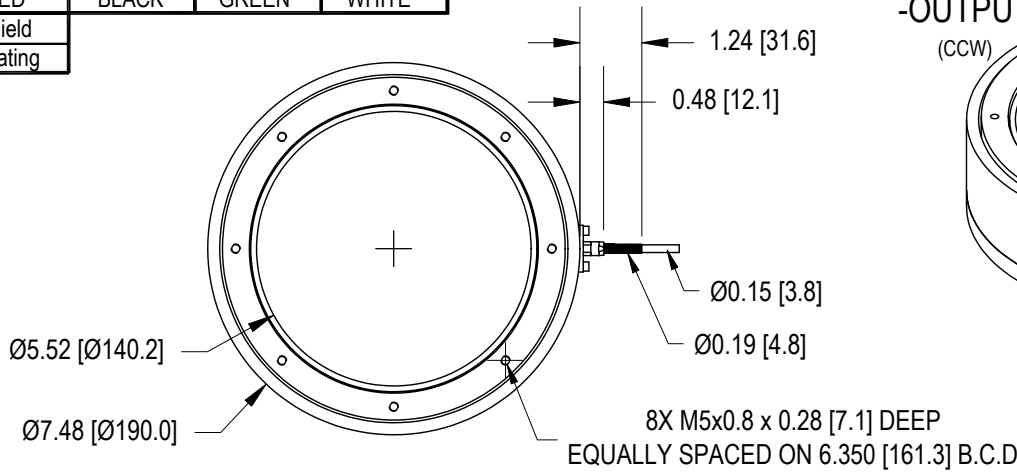
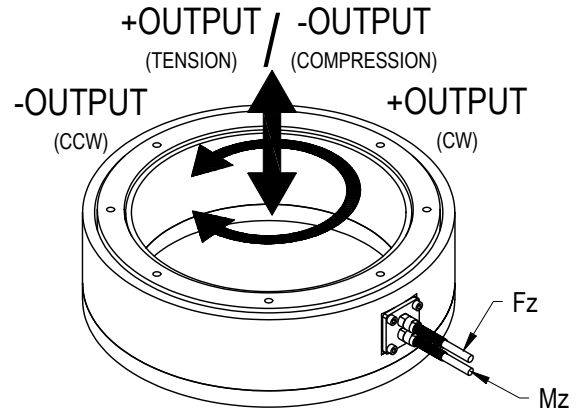

## SPECIFICATIONS:

<b>RATED OUTPUT</b>	2 mV/V nom (Fz), 0.5 mV/V nom (Mz)
<b>CAPACITY</b>	2000 lb (Fz), 150 in-lb (Mz)
<b>SAFE OVERLOAD</b>	150% of R.O.
<b>ZERO BALANCE</b>	±3% of R.O.
<b>EXCITATION (VDC OR VAC)</b>	15 MAX
<b>BRIDGE RESISTANCE</b>	350/700 Ω nom
<b>NONLINEARITY</b>	±0.5% of R.O.
<b>HYSTERESIS</b>	±0.5% of R.O.
<b>NONREPEATABILITY</b>	0.1% of R.O.
<b>TEMP. SHIFT ZERO</b>	±0.01% of R.O./°F (0.018% of R.O./°C)
<b>TEMP. SHIFT SPAN</b>	±0.01% of LOAD/°F (0.018% of LOAD/°C)
<b>COMPENSATED TEMP.</b>	-65 to 160°F (-54 to 71°C)
<b>OPERATING TEMP.</b>	-65 to 200°F (-54 to 93°C)
<b>WEIGHT</b>	approx 3.3 lb
<b>MATERIAL</b>	Anodized Aluminum
<b>CABLE:</b>	24 Awg, 4 Conductor Braided Shielded Teflon Cable, 10 ft [3m] Long

CUSTOMER APPROVAL-COMPANY

## OUTLINE DRAWING

**FUTEK**

This drawing, including all information depicted herein (collectively, "Drawing"), is FUTEK's property and protected under applicable law, including copyright. FUTEK reserves all rights. The Drawing is provided solely for your information and exclusive use. Except as expressly approved by FUTEK in writing, you may not reproduce or share this Drawing, in whole or part, with any other firm or individual, or attempt to reverse engineer the Drawing or data contained therein. Any reproduction of this Drawing in whole or part must include this legend.

CUSTOMER APPROVAL-NAME /DATE

STANDARD NOTES: (Unless Otherwise Specified)

**CAGE: 1X8M6**

REVISIONS: (Refer to dwg # revision sheet)

- ALL DIMENSIONS ARE IN INCHES
- DRAWING INTERPRETATION DIMS. PER ASME-Y14.5M
- REMOVE BURRS AND BREAK SHARP EDGES .005 - .015
- THREADS PER HANDBOOK H-28
- DIMENSIONS ARE SHOWN AFTER PLATING

ANGLE:

±1/2°

CHAMFER:

±5°

TOLERANCE:

.X ±0.1

.XX ±0.01

.XXX ±0.005

3rd ANGLE PROJ.



MODEL: **QMA123**

DWG No.: **FO1253**

DRAWN BY: R. WALKER

CHECKED BY: J. VARGAS

APPROVED BY: -

DATE: **Sept. 28, 2009**

