

Terms and Conditions of Use

This drawing, including all information depicted herein (collectively, "Drawing"), is FUTEK's property and protected under applicable law, including copyright. FUTEK reserves all rights. The Drawing is provided solely for your information and exclusive use. **Except as expressly approved by FUTEK in writing, you may not reproduce or share this Drawing**, in whole or part, with any other firm or individual, or attempt to reverse engineer the Drawing or data contained therein. Any reproduction of this Drawing in whole or part must include this legend.

By accessing the Drawing, you agree that you have read, understand, and agree to abide by the stated Terms and Conditions of Use.

© 2023 FUTEK Advanced Sensor Technology, Inc.

Custom 2 Axis Shear Pin Load Cell

Fz
+ Output

WIRING CODE (Channel Fz)			
+Excitation	-Excitation	+Signal	-Signal
PIN A	PIN B	PIN C	PIN D

WIRING CODE (Channel Fy) Δ			
+Excitation	-Excitation	+Signal	-Signal
PIN E	PIN F	PIN G	PIN H

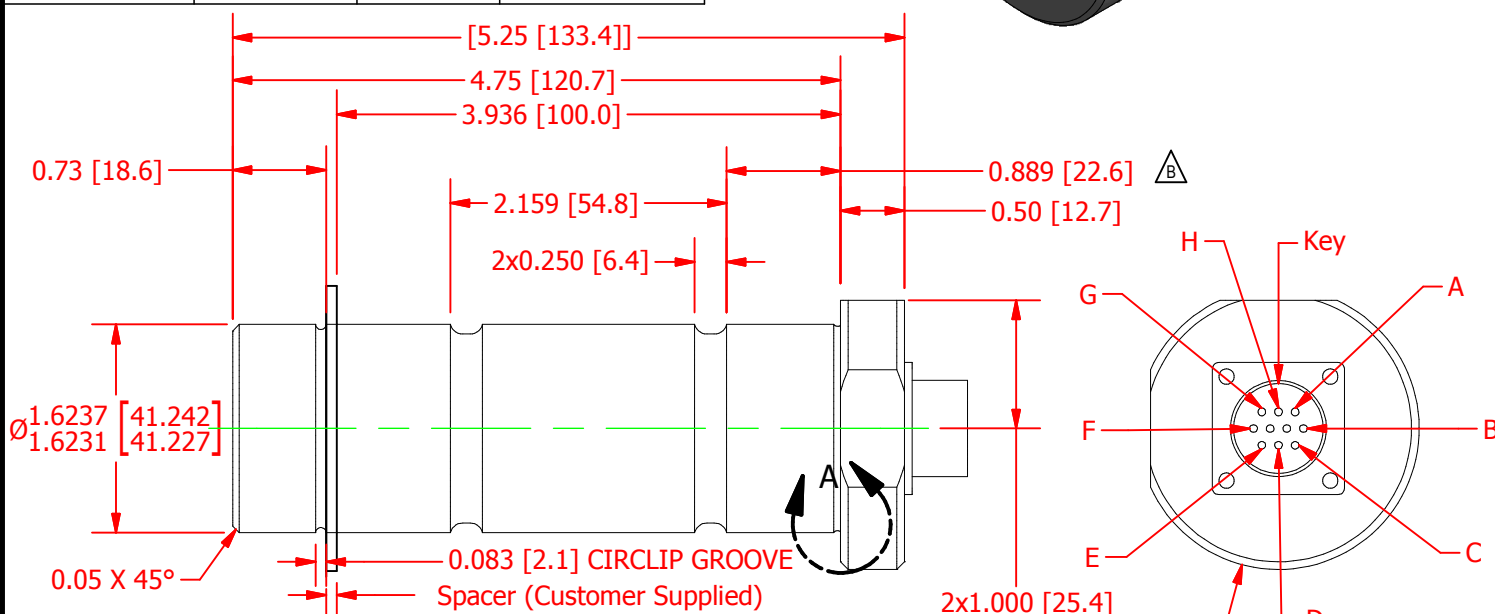
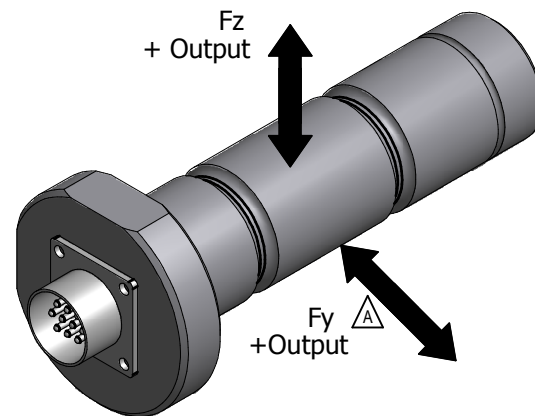

RATED OUTPUT
CAPACITY
SAFE OVERLOAD
ULTIMATE OVERLOAD
EXCITATION (VDC OR VAC)
BRIDGE RESISTANCE
NONLINEARITY
HYSTERESIS
NONREPEATABILITY
CROSS TALK
TEMP. SHIFT ZERO
TEMP. SHIFT SPAN
COMPENSATED TEMP.
OPERATING TEMP
WEIGHT (approx)
MATERIAL
CONNECTOR: PC02E-12-10P

3.0 mV/V nom. (Fy); 1.0 mV/V nom. (Fz)
81 klb [360.3 kN] Fy; 32 klb [142.3 kN] Fz
Fy: 110% of R.O. ; Fz: 110% of R.O.
Fy: 180% of R.O. ; Fz: 180% of R.O.
15 MAX
350 Ω nom
 $\pm 2\%$ of R.O.
 $\pm 2\%$ of R.O.
 $\pm 0.5\%$ of R.O.
4% of R.O. \triangle_A
 $\pm 0.01\%$ of R.O./ $^{\circ}\text{F}$ (± 0.018 of R.O./ $^{\circ}\text{C}$)
 $\pm 0.02\%$ of LOAD/ $^{\circ}\text{F}$ (± 0.036 of LOAD/ $^{\circ}\text{C}$)
60 to 160 $^{\circ}\text{F}$ (16 to 71 $^{\circ}\text{C}$)
60 to 200 $^{\circ}\text{F}$ (16 to 93 $^{\circ}\text{C}$)
3.35 lb
Steel; Nickel Plated

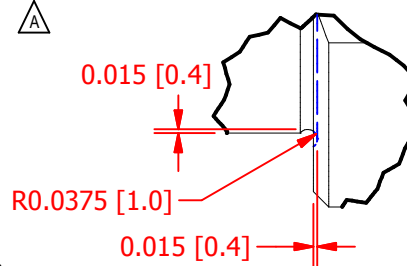
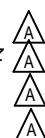

DETAIL A

A	02/14/2012
B	02/16/2012

ALL DIMENSIONS ARE IN INCHES
DRAWING INTERPRETATION DIMS. PER ASME-Y14.5M
REMOVE BURRS AND BREAK SHARP EDGES .005 - .015
THREADS PER HANDBOOK H-28
DIMENSIONS ARE SHOWN AFTER PLATING

TOLERANCE:
 .X \pm 0.1"
 .XX \pm 0.01"
 .XXX \pm 0.005"

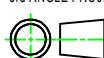

This drawing, including all information depicted herein (collectively, "Drawing"), is FUTEK's property and protected under applicable law, including copyright. FUTEK reserves all rights. The Drawing is provided solely for your information and exclusive use. **Except as expressly approved by FUTEK in writing, you may not reproduce or share this Drawing**, in whole or part, with any other firm or individual, or attempt to reverse engineer the Drawing or data contained therein. Any reproduction of this Drawing in whole or part must include this legend.

FUTEK

CHECKED BY:

CAGE: 1X8M6 SHEET: 1 OF 1