

Terms and Conditions of Use

This drawing, including all information depicted herein (collectively, "Drawing"), is FUTEK's property and protected under applicable law, including copyright. FUTEK reserves all rights. The Drawing is provided solely for your information and exclusive use. **Except as expressly approved by FUTEK in writing, you may not reproduce or share this Drawing**, in whole or part, with any other firm or individual, or attempt to reverse engineer the Drawing or data contained therein. Any reproduction of this Drawing in whole or part must include this legend.

By accessing the Drawing, you agree that you have read, understand, and agree to abide by the stated Terms and Conditions of Use.

© 2023 FUTEK Advanced Sensor Technology, Inc.

FUTEK MODEL QMA133

Reaction Torque and Thrust Flange Sensor

ITEM NUMBER: QSH01622

INCH [mm]		R.O.= Rated Output	
WIRING CODE			
+Excitation	-Excitation	+Signal	-Signal
RED PIN A	BLACK PIN B	GREEN PIN C	WHITE PIN D
+ Sense	- Sense		
ORANGE PIN E	BLUE PIN F		

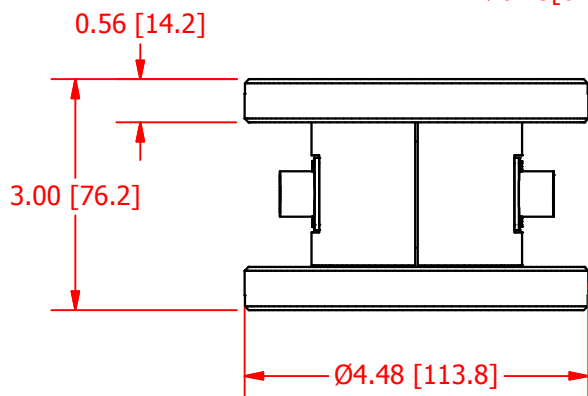
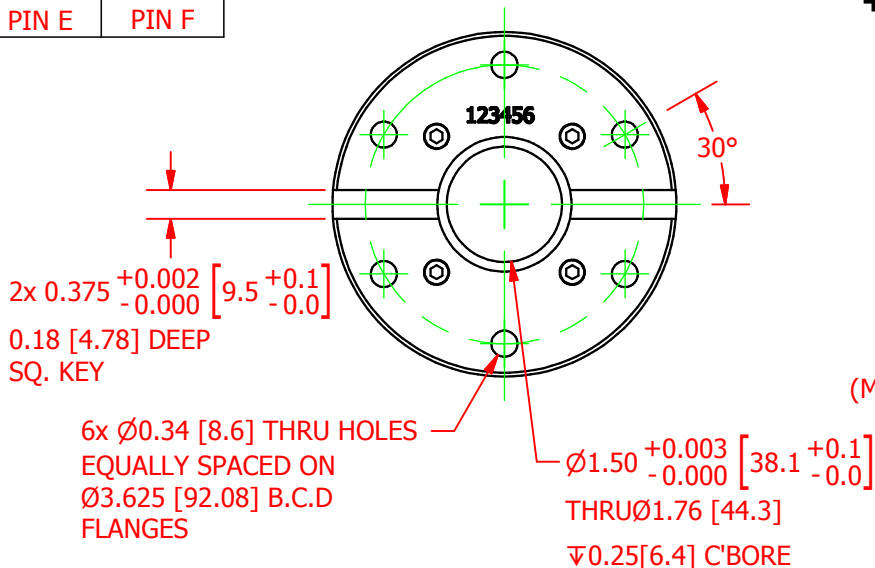
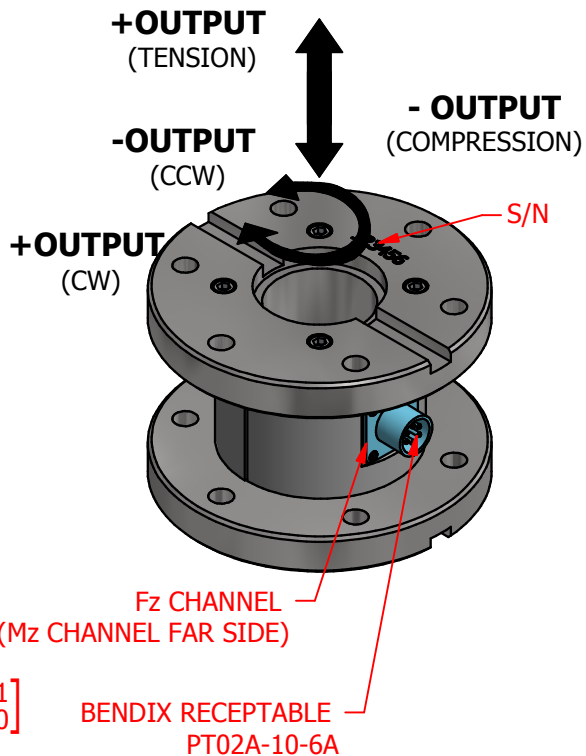

SPECIFICATIONS:

RATED OUTPUT	1 mV/V nom (Fz); 1 mV/V nom (Mz)
CAPACITY	3000 lb (Fz); 1000 in-lb (Mz)
SAFE OVERLOAD	150% of R.O.
ZERO BALANCE	±2% of R.O. (Fz); ±2% of R.O. (Mz)
EXCITATION (VDC OR VAC)	18 MAX
BRIDGE RESISTANCE	372 Ω nom (Fz); 790 Ω nom (Mz)
NONLINEARITY	± 0.5% of R.O (Fz); ± 0.25% of R.O (Mz)
TEMP. SHIFT ZERO	± 0.005% of R.O./°F (± 0.009 of R.O./°C)
TEMP. SHIFT SPAN	± 0.005% of LOAD/°F (± 0.009 of LOAD/°C)
COMPENSATED TEMP.	60 to 160 °F (16 to 71 °C)
OPERATING TEMP	-60 to 200 °F (-51 to 93 °C)
WEIGHT (approx)	2 lb
MATERIAL	Aluminum Flexure, Red Anodized Aluminum (Cover)
CABLE:	2x 6 PIN BENDIX CONNECTOR PTO2A-10-6P

CUSTOMER APPROVAL- COMPANY:

OUTLINE DRAWING

FUTEK

This drawing, including all information depicted herein (collectively, "Drawing"), is FUTEK's property and protected under applicable law, including copyright. FUTEK reserves all rights. The Drawing is provided solely for your information and exclusive use. Except as expressly approved by FUTEK in writing, you may not reproduce or share this Drawing, in whole or part, with any other firm or individual, or attempt to reverse engineer the Drawing or data contained therein. Any reproduction of this Drawing in whole or part must include this legend.

CUSTOMER APPROVAL- NAME / DATE:

STANDARD NOTES: (Unless Otherwise Specified)

REVISIONS: (Refer to dwg # revision sheet)

ALL DIMENSIONS ARE IN INCHES
DRAWING INTERPRETATION DIMS. PER ASME-Y14.5M
REMOVE BURRS AND BREAK SHARP EDGES .005 - .015
THREADS PER HANDBOOK H-28
DIMENSIONS ARE SHOWN AFTER PLATING

ANGLE:
± 1/2°

CHAMFER:
± 5°

3rd ANGLE PROJ.
TOLERANCE:
.X ± 0.1"
.XX ± 0.01"
.XXX ± 0.005"

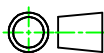

MODEL: **QMA133**

DWG No.: **FO1326**

DRAWN BY: *E. Pano*

CREATED DATE: *8/30/2012*

APPROVED BY: *R. Walker*

APPROVED DATE: *8/30/2012*

CHECKED BY:

CAGE: 1X8M6 SHEET: 1 OF 1