

## Terms and Conditions of Use

This drawing, including all information depicted herein (collectively, "Drawing"), is FUTEK's property and protected under applicable law, including copyright. FUTEK reserves all rights. The Drawing is provided solely for your information and exclusive use. **Except as expressly approved by FUTEK in writing, you may not reproduce or share this Drawing**, in whole or part, with any other firm or individual, or attempt to reverse engineer the Drawing or data contained therein. Any reproduction of this Drawing in whole or part must include this legend.

By accessing the Drawing, you agree that you have read, understand, and agree to abide by the stated Terms and Conditions of Use.

© 2023 FUTEK Advanced Sensor Technology, Inc.

# FUTEK MODEL QMA136

## Custom 2 Axis Shear Pin Load Cell

ITEM NUMBER: QSH01666

INCH [mm]		R.O.= Rated Output	
WIRING CODE (Channel Fz)			
+Excitation	-Excitation	+Signal	-Signal
PIN A	PIN B	PIN C	PIN D
WIRING CODE (Channel Fy)			
+Excitation	-Excitation	+Signal	-Signal
PIN E	PIN F	PIN G	PIN H

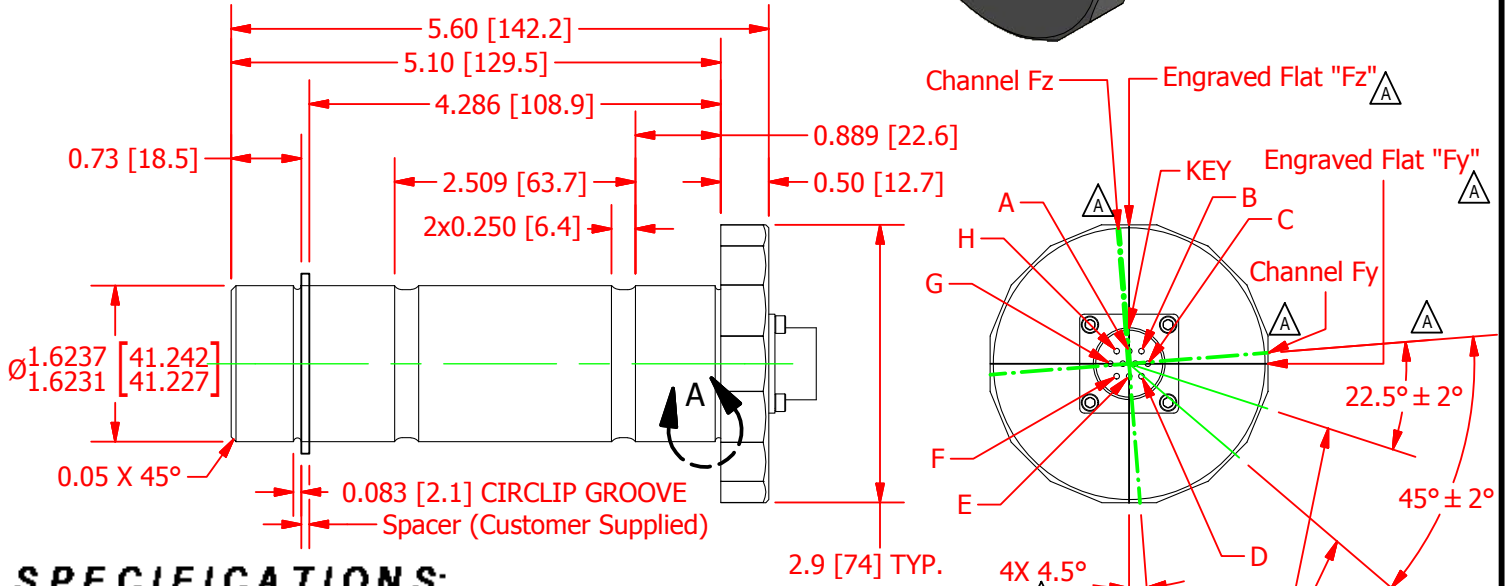
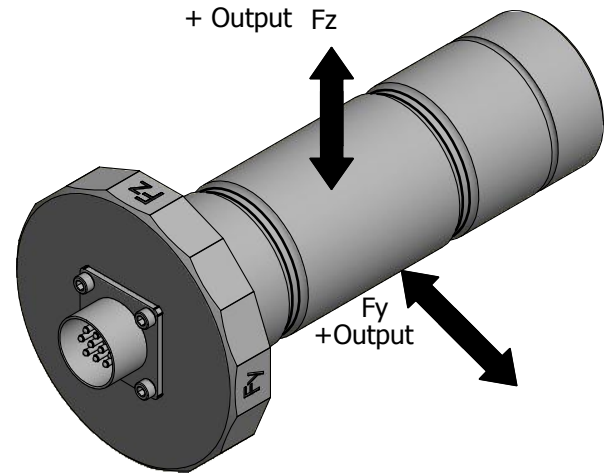

### SPECIFICATIONS:

<b>RATED OUTPUT CAPACITY</b>	4 mV/V nom. Fy; 3.5 mV/V nom. Fz
<b>ULTIMATE OVERLOAD EXCITATION (VDC OR VAC)</b>	71 kdb [15.8 kN] Fy; 63 kdb [280.2 kN] Fz
<b>BRIDGE RESISTANCE</b>	Fy: 150% of R.O.; Fz: 150% of R.O.
<b>NONLINEARITY</b>	15 MAX
<b>HYSTERESIS</b>	350 Ω nom
<b>NONREPEATABILITY</b>	±2% of R.O.
<b>CROSS TALK</b>	±2% of R.O.
<b>TEMP. SHIFT ZERO</b>	±0.5% of R.O.
<b>TEMP. SHIFT SPAN</b>	4% of R.O.
<b>COMPENSATED TEMP.</b>	±0.01% of R.O./F (±0.018 of R.O./C)
<b>OPERATING TEMP</b>	±0.02% of LOAD/F (±0.036 of LOAD/C)
<b>WEIGHT (approx)</b>	60 to 160 °F (16 to 71 °C)
<b>MATERIAL</b>	60 to 200 °F (16 to 93 °C)
<b>CONNECTOR: PC02E-12-10P</b>	3.5 lb
	Steel; Nickel Plated

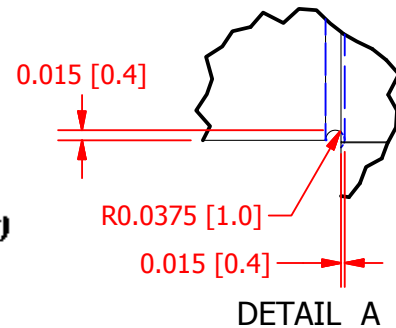

CUSTOMER APPROVAL- COMPANY:

## OUTLINE DRAWING

# FUTEK

This drawing, including all information depicted herein (collectively, "Drawing"), is FUTEK's property and protected under applicable law, including copyright. FUTEK reserves all rights. The Drawing is provided solely for your information and exclusive use. Except as expressly approved by FUTEK in writing, you may not reproduce or share this Drawing in whole or part with any other firm or individual, or attempt to reverse engineer the Drawing or data contained therein. Any reproduction of this Drawing in whole or part must include this legend.

CUSTOMER APPROVAL- NAME / DATE:

STANDARD NOTES: (Unless Otherwise Specified)  
 ALL DIMENSIONS ARE IN INCHES  
 DRAWING INTERPRETATION DIMS. PER ASME-Y14.5M  
 REMOVE BURRS AND BREAK SHARP EDGES .005 - .015  
 THREADS PER HANDBOOK H-28  
 DIMENSIONS ARE SHOWN AFTER PLATING

MODEL: **QMA136**

DWG No.: **FO1346-A**

DRAWN BY: **KL B**

CREATED DATE: 4/9/2013

APPROVED BY: **A. Mehran**

APPROVED DATE: 4/11/2013

CHECKED BY:

CAGE: 1X8M6 SHEET: 1 OF 1

REVISIONS: (Refer to dwg # revision sheet)

A	6-14-13
---	---------

ANGLE: ± 1/2°

CHAMFER: ± 5°

TOLERANCE:  
 .X ± 0.1"  
 .XX ± 0.01"  
 .XXX ± 0.005"

3rd ANGLE PROJ.

