

# FUTEK MODEL QLA133 Custom Pancake Load Cell w/ Built in Amplifier

INCH (mm)		R.O.= Rated Output	
WIRING CODE			
12-24 VDC	GROUND	CURRENT	RETURN (CURRENT)
RED	BLACK	WHITE	BLUE
PIN 'A'	PIN 'B'	PIN 'D'	PIN 'F'

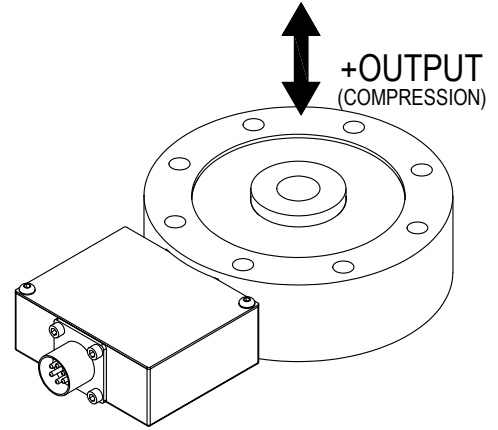
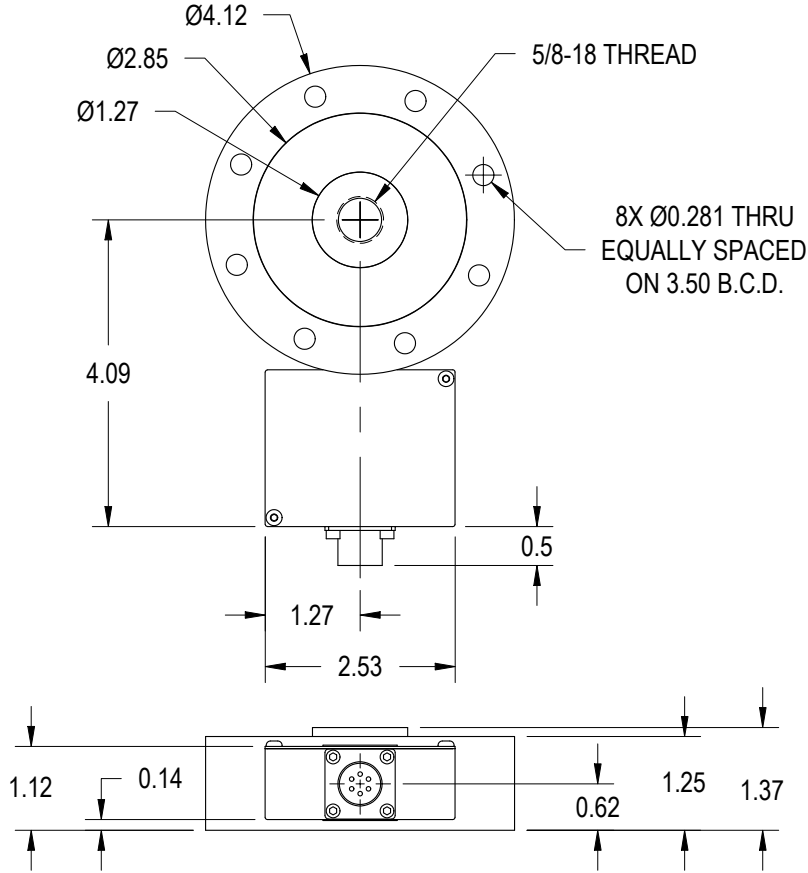

## SPECIFICATIONS:

RATED OUTPUT	20 mA ±0.1%
CAPACITY	200 lb
SAFE OVERLOAD	200% of R.O.
ZERO BALANCE	4 mA ±1%
EXCITATION	12-24 VDC
NONLINEARITY	±0.1% of R.O.
HYSTERESIS	±0.2% of R.O.
NONREPEATABILITY	±0.02% of R.O.
TEMP. SHIFT ZERO	±0.001% of R.O./°F
TEMP. SHIFT SPAN	±0.002% of LOAD/°F
COMPENSATED TEMP.	60 to 160°F
OPERATING TEMP.	32 to 158°F
MATERIAL	ALUMINUM
CONNECTOR:	6 Pin BENDIX Receptacle (PT02A-10-6P)

MATERIAL:

—

HEAT TREATMENT - FINISH:

—

REVISIONS: (Refer to dwg # revision sheet)

- △ 08-05-03
- △ 08-06-03
- △ 09-19-03

## OUTLINE DRAWING

STANDARD NOTES: (Unless Otherwise Specified)

- ALL DIMENSIONS ARE IN INCHES
- DRAWING INTERPRETATION DIMS. PER ASME-Y14.5M
- REMOVE BURRS AND BREAK SHARP EDGES .005 - .015
- THREADS PER HANDBOOK H-28
- DIMENSIONS ARE SHOWN AFTER PLATING

ANGLE:  
±1/2°

CHAMFER:  
±5°

TOLERANCE:  
.XX ±.01  
.XXX ±.005

3rd ANGLE PROJ.

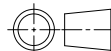

This drawing is submitted solely for the information and exclusive use of the original addressee. It is not to be divulged in whole or in part, by any firm or individual without written permission from:

**FUTEK**  
ADVANCED SENSOR TECHNOLOGY, INC.

10 THOMAS  
IRVINE, CA 92618 USA  
Phone: (949) 465-0900  
Fax: (949) 465-0905

CAGE: 1X8M6

MODEL: **QLA133**

DRAWN BY: R. WALKER

APPROVED BY: J. MOKHBERY

DWG No.: **FO1009**

CHECKED BY: XXXXX

DATE: **Aug 1, 2003**