

# FUTEK MODEL LTH400 CUSTOM DONUT LOAD CELL, HIGH PRESSURE AND TEMPERATURE RANGE

ITEM NUMBER: QSH01480

INCH [mm] | R.O.= Rated Output

WIRING CODE			
+Excitation	-Excitation	+Signal	-Signal
RED	BLACK	GREEN	WHITE

Shield
Floating

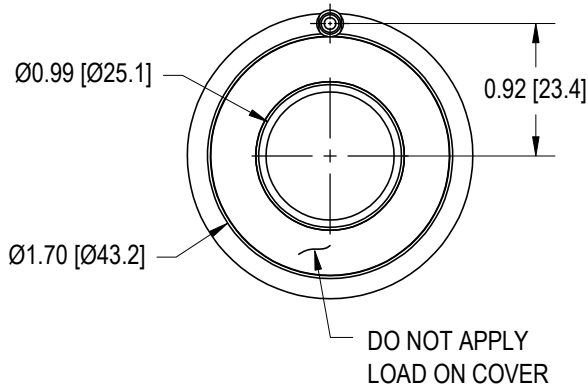
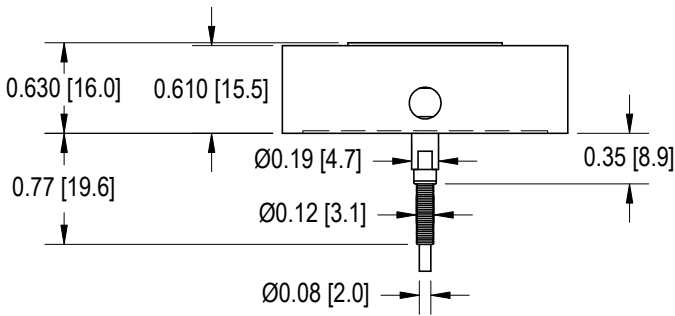
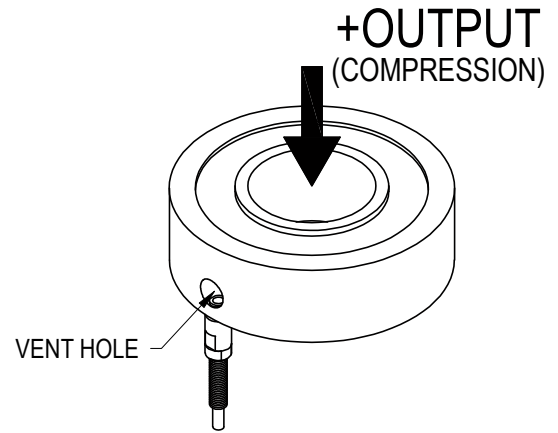
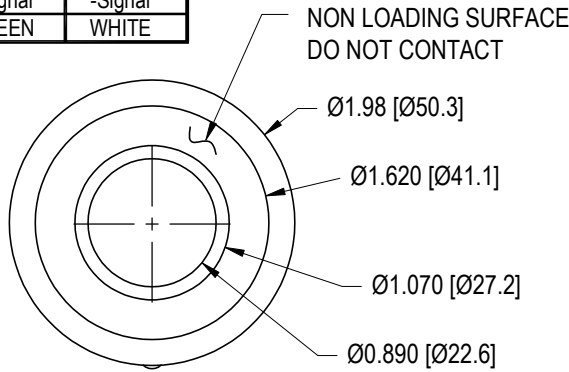

### NOTES:

- 1) MAX ALLOWABLE PRESSURE 20,000 PSI
- 2) SENSOR TO BE USED IN NONCONDUCTIVE OIL ONLY
- 3) CALIBRATION TO BE PERFORMED AT 73°F ±10 AND 1 ATMOSPHERIC PRESSURE.

### SPECIFICATIONS:

RATED OUTPUT	1.5 mV/V nom.
CAPACITY	350 lb [1557 N]
SAFE OVERLOAD	150% of R.O.
ZERO BALANCE	±3% of R.O.
EXCITATION (VDC OR VAC)	18 MAX
BRIDGE RESISTANCE	700 Ω nom
NONLINEARITY	±0.5% of R.O.
HYSTERESIS	±0.5% of R.O.
NONREPEATABILITY	±0.5% of R.O.
TEMP. SHIFT ZERO	±0.01% of R.O./°F (0.018% of R.O./°C)
TEMP. SHIFT SPAN	±0.01% of LOAD/°F (0.018% of LOAD/°C)
COMPENSATED TEMP.	70 to 350°F (21 to 176°C)
OPERATING TEMP.	-60 to 350°F (-51 to 176°C)
MATERIAL	STAINLESS STEEL
CABLE:	29 AWG, 4 Conductor Spiral Shielded Teflon Cable, 10 ft [3 m] long

CUSTOMER APPROVAL-COMPANY

## OUTLINE DRAWING

CUSTOMER APPROVAL-NAME /DATE

STANDARD NOTES: (Unless Otherwise Specified)

- ALL DIMENSIONS ARE IN INCHES
- DRAWING INTERPRETATION DIMS. PER ASME-Y14.5M
- REMOVE BURRS AND BREAK SHARP EDGES .005 - .015
- THREADS PER HANDBOOK H-28
- DIMENSIONS ARE SHOWN AFTER PLATING

ANGLE:  
±1/2°

CHAMFER:  
±5°

TOLERANCE:  
.X ±0.1  
.XX ±0.01  
.XXX ±0.005

3rd ANGLE PROJ.

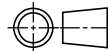

This drawing is submitted solely for the information and exclusive use of the original addressee. It is not to be divulged in whole or in part, by any firm or individual without written permission from:

**FUTEK**  
ADVANCED SENSOR TECHNOLOGY, INC.

10 THOMAS  
IRVINE, CA 92618 USA  
Phone: (949) 465-0900  
Fax: (949) 465-0905

CAGE: 1X8M6

MODEL: LTH400

DWG No.: FO1286

DRAWN BY: R. WALKER

CHECKED BY: A. SATA

APPROVED BY: -

DATE: Feb 24, 2011

REVISIONS: (Refer to dwg # revision sheet)

△ -