

# FUTEK MODEL LSM300

ITEM NUMBER: QSH01697

## PARALLELOGRAM LOAD CELL W/ OVERLOAD PROTECTION AND INLINE AMPLIFIER

INCH [mm]   R.O.= Rated Output		
WIRING CODE (CC1C)		
Power Supply (+)	Ground(-)	Voltage Output (+)
RED	BLACK	Green

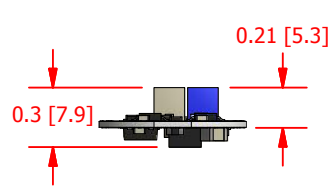
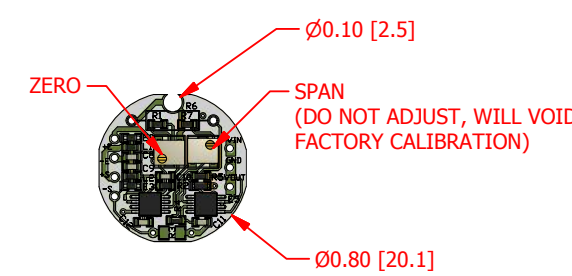
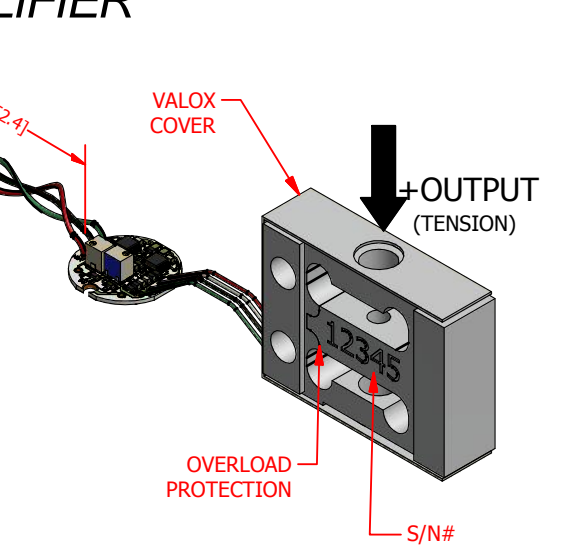
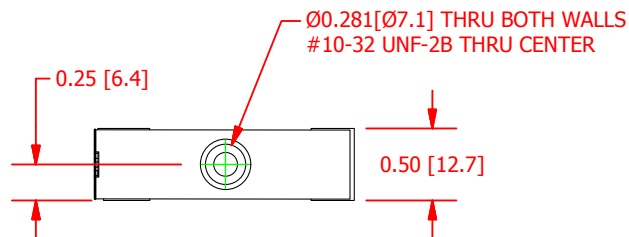
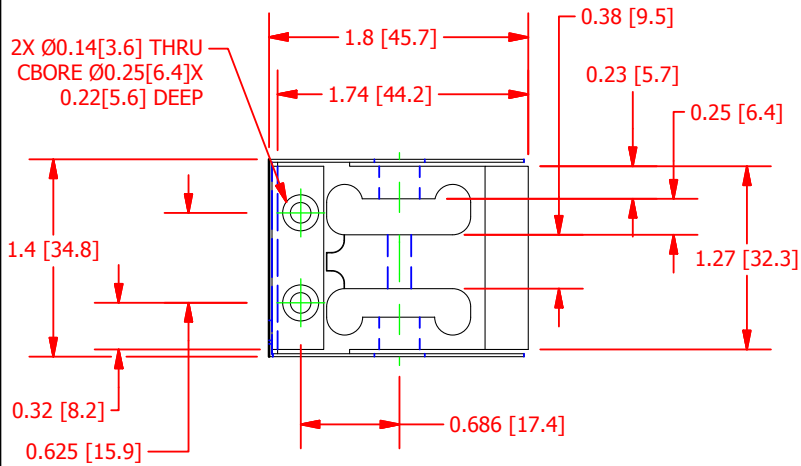

### SPECIFICATIONS:

<b>RATED OUTPUT</b>	<b>8VDC</b>
<b>CAPACITY</b>	<b>25 lb [111N]</b>
<b>SAFE OVERLOAD</b>	<b>250 lb</b>
<b>ZERO BALANCE</b>	<b>1VDC</b>
<b>POWER SUPPLY</b>	<b>12-24 VDC</b>
<b>NONLINEARITY</b>	<b>±0.05% of R.O.</b>
<b>HYSTERESIS</b>	<b>±0.05% of R.O.</b>
<b>NONREPEATABILITY</b>	<b>±0.02% of R.O.</b>
<b>TEMP. SHIFT ZERO</b>	<b>±0.007% of R.O./°F (±0.013 of R.O./°C)</b>
<b>TEMP. SHIFT SPAN</b>	<b>±0.007% of LOAD/°F (±0.013 of LOAD/°C)</b>
<b>COMPENSATED TEMP.</b>	<b>60 to 160°F (15 to 71°C)</b>
<b>OPERATING TEMP</b>	<b>-45 to 185°F (-43 to 84°C)</b>
<b>WEIGHT (approx)</b>	<b>0.2 lb [0.335 kg] System Weight</b>
<b>MATERIAL (Sensor)</b>	<b>Aluminum</b>
<b>CABLE:</b>	<b>#29AWG, 4 Conductor, Spiral Teflon Cable, 6 in. [152.4 mm] Long</b>

CUSTOMER APPROVAL- COMPANY:

CUSTOMER APPROVAL- NAME / DATE:

REVISIONS: (Refer to dwg # revision sheet)

## OUTLINE DRAWING

STANDARD NOTES: (Unless Otherwise Specified)

ALL DIMENSIONS ARE IN INCHES  
DRAWING INTERPRETATION DIMS. PER ASME-Y14.5M  
REMOVE BURRS AND BREAK SHARP EDGES .005 - .015  
THREADS PER HANDBOOK H-28  
DIMENSIONS ARE SHOWN AFTER PLATING

ANGLE:  
± 1/2°

CHAMFER:  
± 5°

TOLERANCE:  
.X ± 0.1"  
.XX ± 0.01"  
.XXX ± 0.005"

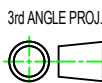

This drawing is submitted solely for the information and exclusive use of the original addressee. It is not to be divulged in whole or in part, by any firm or individual without written permission from:

**FUTEK**  
ADVANCED SENSOR TECHNOLOGY, INC.  
10 THOMAS, IRVINE, CA 92618 USA  
Phone: (949) 465-0900  
Fax: (949) 465-0905

MODEL: **LSM300**

DWG No.: **FO1353**

DRAWN BY: *E. Pano*

CREATED DATE: *5/20/2015*

APPROVED BY: \_\_\_\_\_

APPROVED DATE:

CHECKED BY:

CAGE: 1X8M6 SHEET: 1 OF 1