

FUTEK MODEL QLA376

ITEM NUMBER: QSH01708

DUAL CHANNEL PARALLELOGRAM LOAD CELL W/ OVERLOAD PROTECTION AND INLINE AMPLIFIERS



INCH [mm] R.O.= Rated Output		
WIRING CODE		
Power Supply (+)	Ground(-)	Voltage Output (+)
RED	BLACK	Green

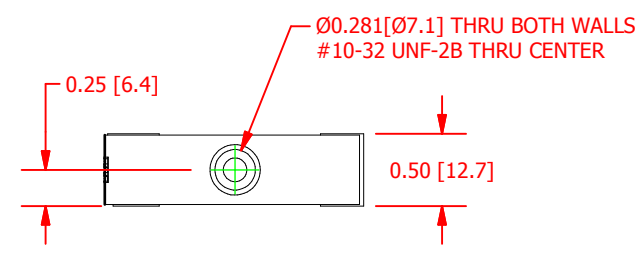
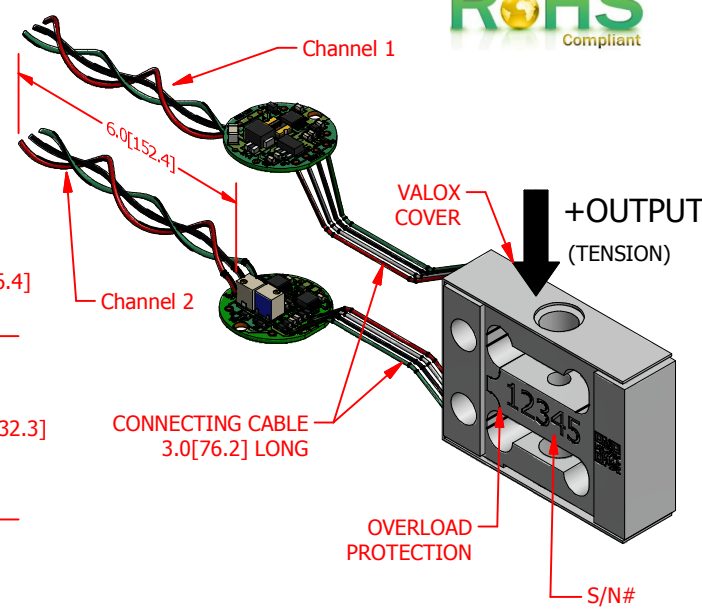
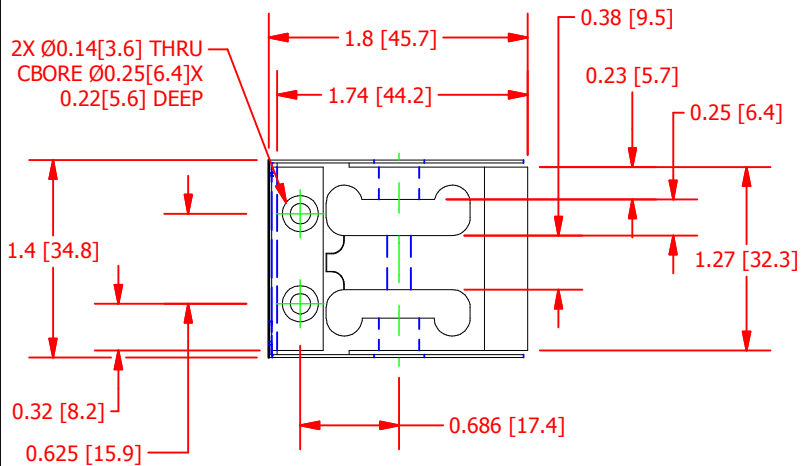

SPECIFICATIONS

RATED OUTPUT	8 VDC
CAPACITY	15 lb [0.067kN]
SAFE OVERLOAD	250 lb
ZERO BALANCE	1 VDC
EXCITATION	12-24 VDC MAX
NONLINEARITY	±0.075 of R.O.
HYSTERESIS	±0.075 of R.O.
NONREPEATABILITY	±0.05 of R.O.
TEMP. SHIFT ZERO	±0.007 of R.O./°F (±0.013 of R.O./°C)
TEMP. SHIFT SPAN	±0.007 of LOAD/°F (±0.013 of LOAD/°C)
COMPENSATED TEMP.	60 to 160 °F (15.56 to 71.11 °C)
OPERATING TEMP	-40 to 185 °F (-40 to 85 °C)
WEIGHT (approx)	0.2 lb
MATERIAL	Aluminum
CABLE (From Load Cell to Amplifier)	#29 AWG, 4 Conductor, Spiral Teflon Cable
CABLE (From Amplifier)	#26 AWG, 4 Conductor, Spiral Teflon Cable

SBA00230 AMPLIFIER DETAIL

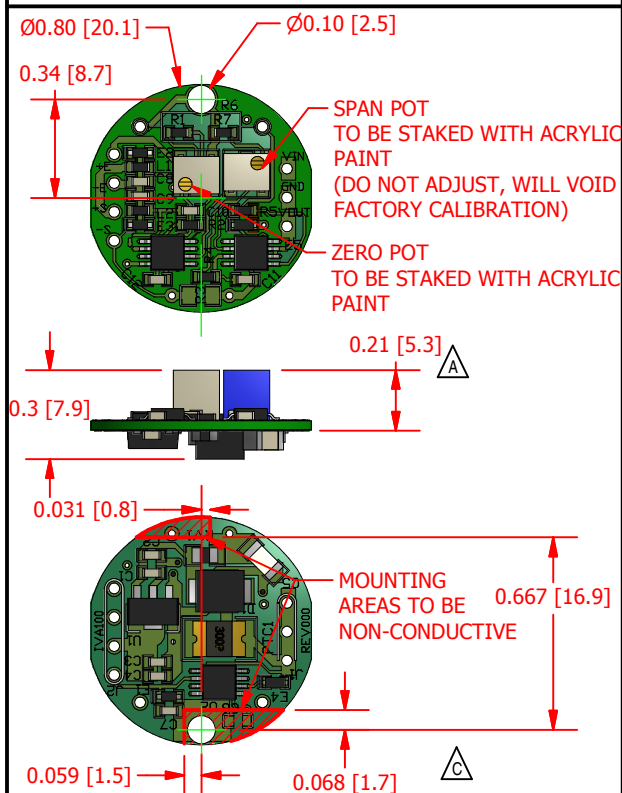

CUSTOMER APPROVAL- COMPANY:

OUTLINE DRAWING

This drawing is submitted solely for the information and exclusive use of the original addressee. It is not to be divulged in whole or in part, by any firm or individual without written permission from:

FUTEK
ADVANCED SENSOR TECHNOLOGY, INC.
10 THOMAS, IRVINE, CA 92618 USA
Phone: (949) 465-0900
Fax: (949) 465-0905

CUSTOMER APPROVAL- NAME / DATE:

STANDARD NOTES: (Unless Otherwise Specified)
ALL DIMENSIONS ARE IN INCHES
DRAWING INTERPRETATION DIMS. PER ASME-Y14.5M
REMOVE BURRS AND BREAK SHARP EDGES .005 - .015
THREADS PER HANDBOOK H-28
DIMENSIONS ARE SHOWN AFTER PLATING

ANGLE:
± 1/2°

CHAMFER:
± 5°

3rd ANGLE PROJ.
TOLERANCE:
.X ± 0.1"
.XX ± 0.01"
.XXX ± 0.005"

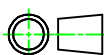

MODEL: **QLA376**

DWG No.: **FO1357-C**

DRAWN BY: E. Pano

CREATED DATE: 8/26/2013

APPROVED BY: R. Walker

APPROVED DATE: 12/4/2013

CHECKED BY:

CAGE: 1X8M6 SHEET: 1 OF 1

REVISIONS: (Refer to dwg # revision sheet)

A	12/12/2013
B	12/16/2013
C	3/12/2015