

FUTEK MODEL LLB130-TPS

ITEM NUMBER: TPS01001

INCH [mm] | R.O.= Rated Output

SUBMINIATURE LOAD BUTTON LOAD CELL SYSTEM w/ HIGH RESOLUTION AND PERFORMANCE USB

Preliminary Drawing

NON LOADING SURFACE
DO NOT CONTACT

+ OUTPUT
(COMPRESSION)

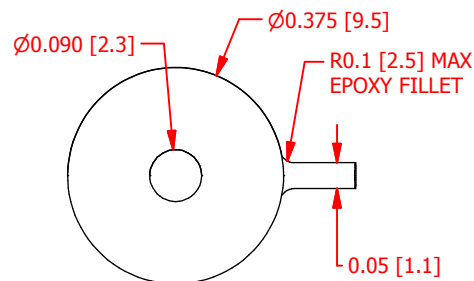
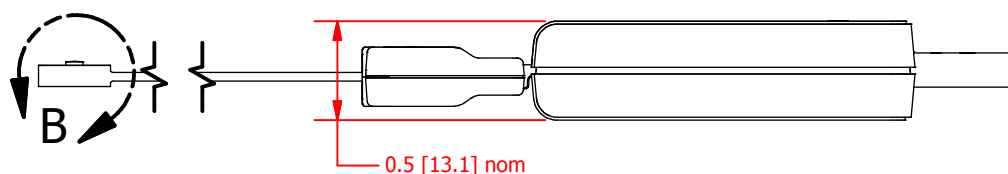
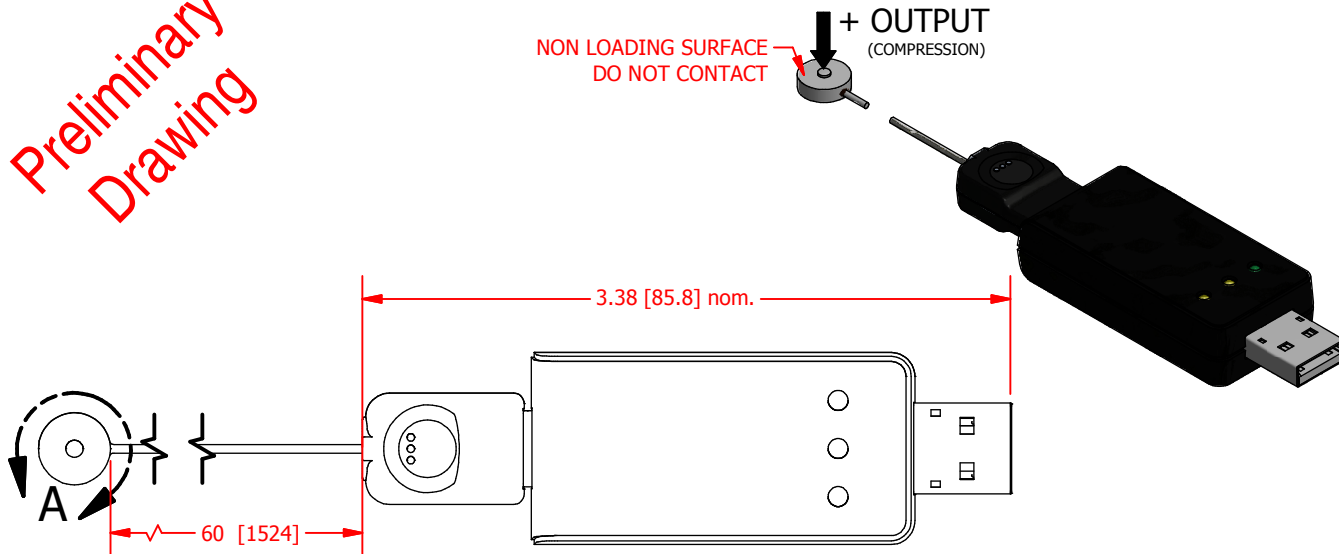

DETAIL A

SPECIFICATIONS:

CAPACITY	50 lb [222 N]
RESOLUTION MAX	0.00011 lb @ 5 SAMPLES/SEC
RESOLUTION MIN	0.029 lb @ 4800 SAMPLES/SEC
SAMPLING RATE	5 - 4800 SAMPLES/SEC
SAFE OVERLOAD	75 lb [333 N]
EXCITATION (VDC OR VAC)	POWERED BY USB
SENSOR OPERATING TEMP	-60 to 200 °F (-51 to 93 °C)
ELECTRONICS OPERATING TEMP	-13 to 185 °F (-25 to 85 °C)
SENSOR MATERIAL	17-4 PH S.S.
CABLE: #34 Aw g Braided Shield Cable , 5.0 ft [1.5 m] Long	
CALIBRATION	5 pt compression NIST traceable in lb units

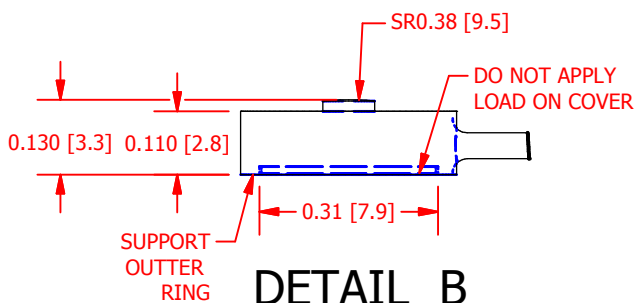

DETAIL B

CUSTOMER APPROVAL- COMPANY:	<h2 style="color: green; margin: 0;">OUTLINE DRAWING</h2>	This drawing is submitted solely for the information and exclusive use of the original addressee. It is not to be divulged in whole or in part, by any firm or individual without written permission from:
CUSTOMER APPROVAL- NAME / DATE:	STANDARD NOTES: (Unless Otherwise Specified) ALL DIMENSIONS ARE IN INCHES DRAWING INTERPRETATION DIMS. PER ASME-Y14.5M REMOVE BURRS AND BREAK SHARP EDGES .005 - .015 THREADS PER HANDBOOK H-28 DIMENSIONS ARE SHOWN AFTER PLATING	FUTEK ADVANCED SENSOR TECHNOLOGY, INC. 10 THOMAS, IRVINE, CA 92618 USA Phone: (949) 465-0900 Fax: (949) 465-0905
REVISIONS: (Refer to dwg # revision sheet)	<p>ANGLE: ± 1/2°</p> <p>CHAMFER: ± 5°</p> <p>3rd ANGLE PROJ.</p> <p>TOLENANCE: .X ± 0.1" .XX ± 0.01" .XXX ± 0.005"</p>	<p>MODEL: LLB130-TPS DWG No.: FO1375</p> <p>DRAWN BY: <i>E. Pano</i> CREATED DATE: 9/12/2014</p> <p>APPROVED BY: _____ APPROVED DATE:</p> <p>CHECKED BY: _____ CAGE: 1X8M6 SHEET: 1 OF 1</p>