

Terms and Conditions of Use

This drawing, including all information depicted herein (collectively, "Drawing"), is FUTEK's property and protected under applicable law, including copyright. FUTEK reserves all rights. The Drawing is provided solely for your information and exclusive use. **Except as expressly approved by FUTEK in writing, you may not reproduce or share this Drawing**, in whole or part, with any other firm or individual, or attempt to reverse engineer the Drawing or data contained therein. Any reproduction of this Drawing in whole or part must include this legend.

By accessing the Drawing, you agree that you have read, understand, and agree to abide by the stated Terms and Conditions of Use.

© 2023 FUTEK Advanced Sensor Technology, Inc.

FUTEK MODEL QLA383-TPS

Low Profile Portable Calibration Tripod

ITEM NUMBER: TPS01016

INCH [mm] | R.O.= Rated Output

Ø0.1 [2.5] Loading Region Indicated By Marking

Ø2.9 [73.7]

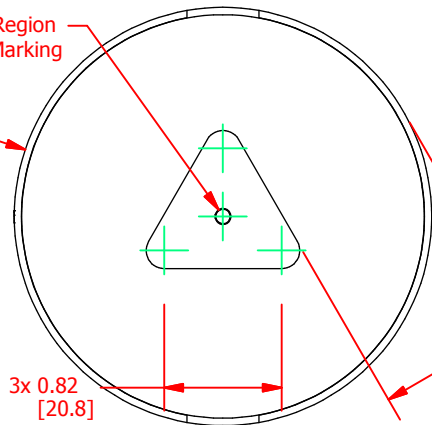

3x 0.82 [20.8]

1.09 TYP [27.7]

+ OUTPUT (COMPRESSION)
NON LOADING REGION

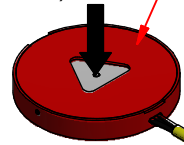

BRAIDED MESH SLEEVING

3x USB220

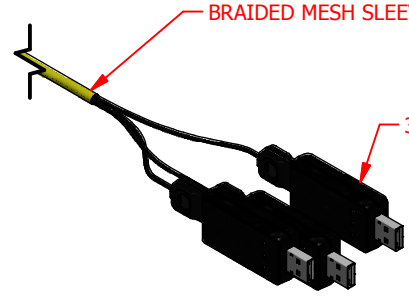

Loading Region

0.382 [9.70]

0.43 [10.8]

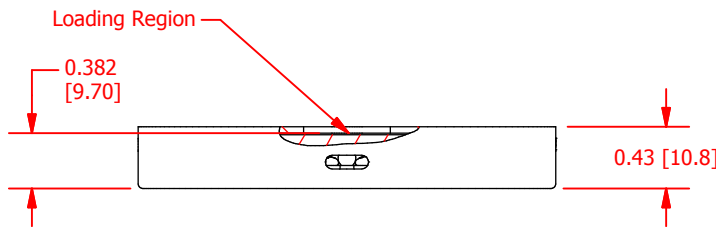

M4 Dowel Pin Hole
Ø0.16 ±0.05 MAX
[4.1 ± 1.3 MAX]

1.200 +0.001
-0.000
[30.48 +0.03
-0.00]

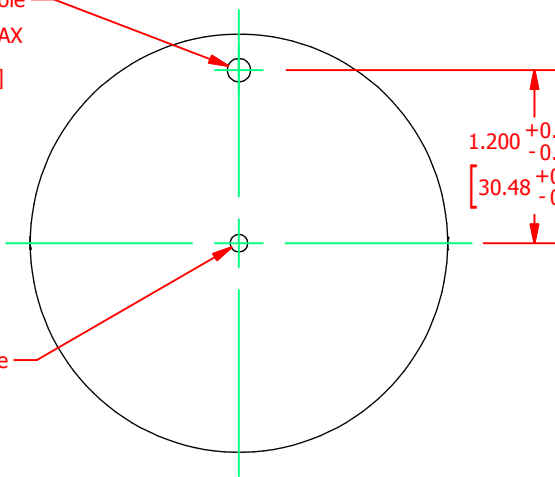

M3 Dowel Pin Hole
Ø0.12 ±0.05
[3.0 ± 1.3 MAX]

SPECIFICATIONS:

OUTPUT	USB2.0
CAPACITY	1000 g
RESOLUTION	0.01 g
MAXIMUM LOAD	2000 g
WEIGHT (approx)	90 g
MATERIAL	Aluminum

CABLE: 3x 29 AWG Spiral Shielded Silicone, 5 ft [1.5 m] Long

Preliminary Drawing

CUSTOMER APPROVAL- COMPANY:	
CUSTOMER APPROVAL- NAME / DATE:	
REVISIONS: (Refer to dwg # revision sheet)	

OUTLINE DRAWING

STANDARD NOTES: (Unless Otherwise Specified)

ALL DIMENSIONS ARE IN INCHES
DRAWING INTERPRETATION DIMS. PER ASME-Y14.5M
REMOVE BURRS AND BREAK SHARP EDGES .005 - .015

ANGLE: ± 1/2°
CHAMFER: ± 5°
3rd ANGLE PROJ.

TOLENANCE:
.X ± 0.1"
.XX ± 0.01"
.XXX ± 0.005"

FUTEK

MODEL: QLA383-TPS DWG No.: FO1382

DRAWN BY: E. Pano CREATED DATE: 11/25/2014

APPROVED BY: _____ APPROVED DATE: _____

CHECKED BY: M. Lisiak CAGE: 1X8M6 SHEET: 1 OF 1

This drawing including all information depicted herein (collectively, "Drawing") is FUTEK's property and protected under applicable law, including copyright. FUTEK reserves all rights. The Drawing is provided solely for your information and exclusive use. Except as expressly approved by FUTEK in writing, you may not reproduce or share this Drawing in whole or part with any other firm or individual, or attempt to reverse engineer the Drawing or data contained therein. Any reproduction of this Drawing in whole or part must include this legend.