

FUTEK MODEL TRD600

NON CONTACT SQUARE DRIVE ROTARY TORQUE SENSOR

Drawing Number: FI1026-C

INCH [mm] | R.O.= Rated Output



BINDER RECEPTACLE
09-0331-90-12
(MATING CONNECTOR
99-2030-09-12
NOT INCLUDED)

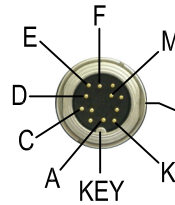

-OUTPUT
(CCW) **+OUTPUT**
(CW)

CONNECTOR CODE (CABLE PACKAGE WIRING CODE)			
Power	Ground	Signal	Return (Signal)
PIN 'F' (RED)	PIN 'E' (BLACK)	PIN 'C' (GREEN)	PIN 'D' (WHITE)
Shield	Shunt Cal	Shunt Cal (Gnd)	
PIN 'M' (Floating)	PIN 'K' (PURPLE)	PIN 'A' (YELLOW)	

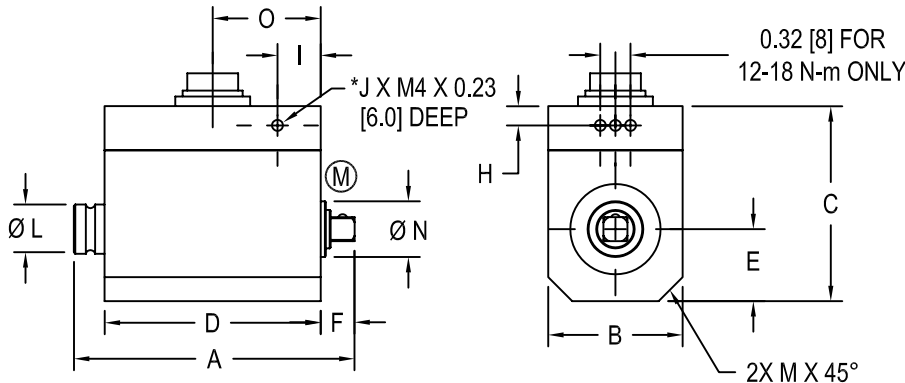

(M) = MEASURING SIDE

TORQUE SENSOR WITH SQUARE DRIVE PER DIN 3121 E,F,G & H.

* ANTI-ROTATION HOLES, NOT TO BE USED TO SUPPORT LOAD.

** MAXIMUM LOAD ALLOWED, NOT FOR MEASUREMENT.

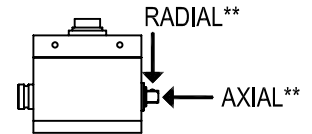

ITEM #	Capacity in-lb N m	Sq. Drive	A	B	C	D	E	F	H	I	J	Ø L	M	Ø N	O	**MAX.AXIAL FORCE lb[N]	**MAX.RADIAL FORCE lb[N]	ROTATIONAL SPEED (MAX)	WEIGHT lb[kg]		
FSH02008	106 12	1/4"	2.95	1.1	2.04	2.28	0.55	0.33	0.19	0.43	6	0.51	0.32	0.393	1.46	34	6.8	12000 RPM	0.7 [0.30]		
FSH02009	159 18		[75]	[28]	[52]	[58]	[14]	[8.5]	[5]	[11]		[13]	[8]	[10]	[37]	[150]	[30]				
FSH02010	443 50	3/8"	2.93	1.49	2.28	1.73	0.75	0.71	0.24	0.87	3	0.98	0.40	0.75	0.91	112	13.5	9000 RPM	0.8 [0.36]		
FSH02011	558 63		[74.5]	[38]	[58]	[44]	[19]	[18]	[6]	[22]		[25]	[10]	[19]	[23]	[500]	[60]				
FSH02012	885 100	1/2"	3.11	1.49	2.28	1.73	0.75	0.89	0.24	0.87	3	0.98	0.40	0.75	0.91	157 [700]	22.5 [100]			7000 RPM	0.9 [0.40]
FSH02013	1328 150		[79]	[38]	[58]	[44]	[19]	[22.5]	[6]	[22]		[25]	[10]	[19]	[23]	225 [1000]	22.5 [100]				
FSH02014	1416 160																				
FSH02015	2213 250	3/4"	3.82	2.28	2.99	1.97	1.14	1.18	0.19	0.98	3	1.57	0.40	1.18	1.06	450	34	7000 RPM	2.2 [1.00]		
FSH02016	2655 300		[97]	[58]	[76]	[50]	[29]	[30]	[5]	[25]		[40]	[10]	[30]	[27]	[2000]	[150]				
FSH02017	4425 500																				
FSH02018	8851 1000	1"	4.41	2.87	3.54	2.24	1.43	1.36	0.19	1.12	3	1.97	0.71	1.57	1.10	900	56		3.1 [1.40]		
			[112]	[73]	[90]	[57]	[36.5]	[34.5]	[5]	[28.5]		[50]	[18]	[40]	[28]	[4000]	[250]				

SPECIFICATIONS:

RATED OUTPUT	±5VDC
SAFE OVERLOAD	150% of R.O.
ZERO BALANCE	±1% of R.O.
EXCITATION	11-26 VDC
NONLINEARITY	±0.2% of R.O.
HYSTERESIS	±0.1% of R.O.
NONREPEATABILITY	±0.2% R.O.
TEMP. SHIFT ZERO	±0.01% of R.O. / °F [±0.02% of R.O. / °C]
TEMP. SHIFT SPAN	±0.01% of Load / °F [±0.02% of Load / °C]
OPERATING TEMP.	-13 to 176°F [-25 to +80°C]
COMPENSATED TEMP.	41 to 122°F [+5 to +50°C]

CONNECTOR:	12 pin Binder Series #581 (09-0331-90-12)
ACCESSORIES AND RELATED INSTRUMENTS AVAILABLE	
CALIBRATION (STD)	Certificate of Conformance
CALIBRATION (AVAILABLE)	5pt CW and CCW
CALIBRATION TEST EXCITATION	12 VDC
SHUNT CALIBRATION	With sensor fully connected apply 11-26 VDC to Pins A & K to generate 5VDC nom output.



This drawing is submitted solely for the information and exclusive use of the original addressee. It is not to be divulged in whole or in part, by any firm or individual without written permission from FUTEK

10 THOMAS
IRVINE, CA 92618 USA
1-800-23-FUTEK (38835)

INTERNET:
<http://www.futek.com>