

**WIRING CODE FUTEK 11-PIN CONNECTOR (CC20)**

PIN	COLOR
1	Red
2	Green
3	White
4	Black
5	Orange
6	Blue
7	Brown
8	Gray
9	Violet
10	Yellow
11	Clear

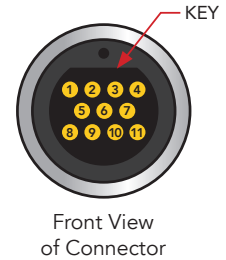
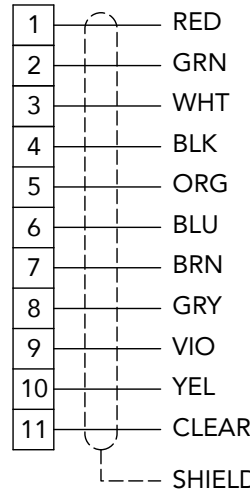

**FEATURES**

- Easily thread on and off from the sensor
- Compatible with LMD300 pinch force sensor
- Connection available for [IEEE1451.4 TEDs](#) and [PT-100 Temperature Sensors](#)
- 90% Braided Shield coverage for optimal EMI protection

**VARIATIONS**

ITEM #	LENGTH [FT]	CABLE/CONNECTORS	MATES TO	TEMPERATURE	SPECIFICATIONS
FSH04516	15	ZCC211 to Cable Assembly	Flying Leads (Bare Wires)	-67 to 221°F (-55 to 105°C)	11 Pin Nano to Cable Assembly, IP67, Material - PVC, 32 AWG 11 Conductor Braided Shielded
FSH04650	15	ZCC211 to Hirose Connector	USB225	-22 to 203°F (-30 to 95°C)	
FSH04655	5	ZCC211 to Binder Male Plug 99 5129 00 12	IHH500/USB520	-22 to 203°F (-30 to 95°C)	

**DIMENSIONS inches [mm]**

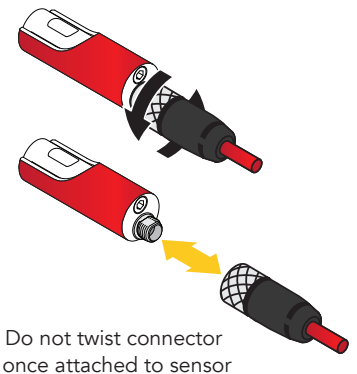
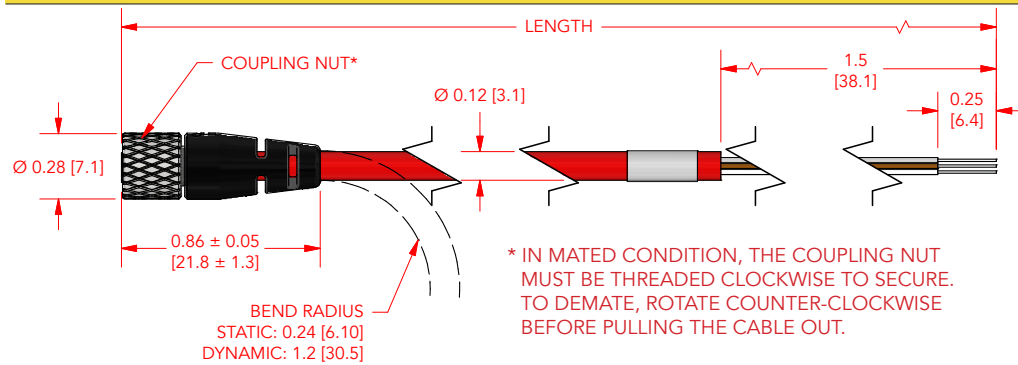

Drawing Number: FI1549

FUTEK reserves the right to modify its design and specifications without notice. Please visit <http://www.futek.com/salesterms> for complete terms and conditions.

10 Thomas, Irvine, CA 92618 USA  
Tel: (949) 465-0900

[www.futek.com](http://www.futek.com)

