

FUTEK Model # ZCO976

Drawing Number: FI1557-B

INCH [mm]

12 Pin Binder Connector

For Mating Keyence LK-G Series With FUTEK Model USB520

⚠ Power off Before Connecting

12 Pin Binder Mating Connector
99 5129 00 12

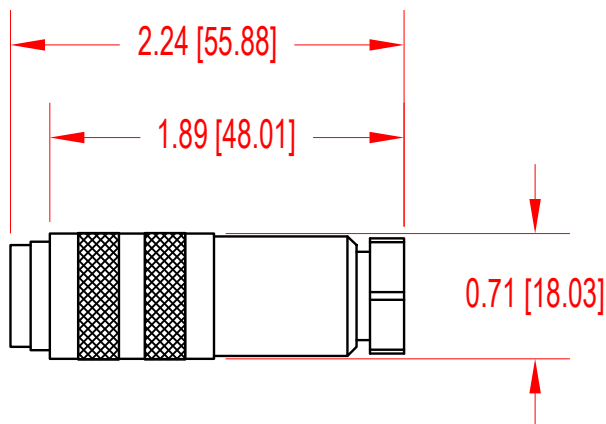
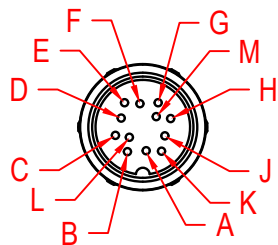

LK-G Series Controller

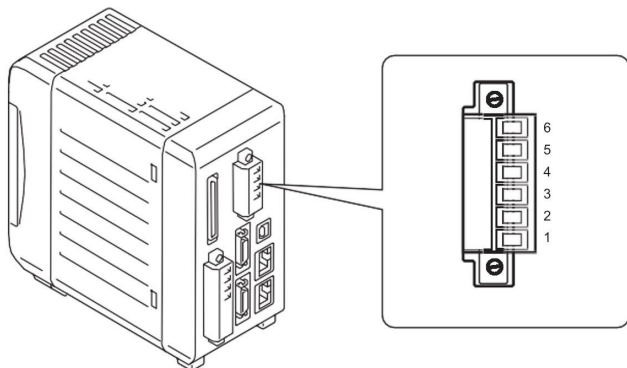

KEYENCE Pin No.	KEYENCE Signal name	KEYENCE Description	Connects to FUTEK Pin	FUTEK Description
6	OT1 (V)	Analog voltage output of OUT1 Outputted in the range of ± 10.8 V with reference to the displayed value.	K	+V
5	OUT1 (A)	Analog current output of OUT1 Outputted in the range of 3.36 mA to 20.64 mA with reference to the displayed value.	K	+V
4	OUT1 0V	0V terminal for OUT1	J	-V
3	OUT2 (V)	Analog voltage output of OUT2 Outputted in the range of ± 10.8 V with reference to the displayed value.	K	+V
2	OUT2 (A)	Analog current output of OUT2 Outputted in the range of 3.36 mA to 20.64 mA with reference to the displayed value.	K	+V
1	OUT2 0V	0V terminal for OUT2	J	-V

* 0V of pin Nos. 1 and 4 are common

* Confirm wiring to avoid short circuits

For Voltage Output:

Connect pin 6/3 of LK-G series controller to pin K of binder and

Connect pin 4/1 of LK-G series controller to pin J of binder

For Current Output:

Connect pin 5/2 of LK-G series controller to pin K of binder and

Connect pin 4/1 of LK-G series controller to pin J of binder

FUTEK
ADVANCED SENSOR TECHNOLOGY, INC.

This drawing is submitted solely for the information and exclusive use of the original addressee. It is not to be divulged in whole or in part, by any firm or individual without written permission from FUTEK

10 THOMAS
IRVINE, CA 92618 USA
+1 (949)465-0900

INTERNET:
<http://www.futek.com>